

# Leamy Avenue Scheme PHASE 1

## Demolish District Admin Wing



Construction of New Facilities Maintenance Building and Renovation of Two Tennis Courts **7,000 GSF**

Loading Access Maintained

Demolition of Existing Distr. Admin. Office and Regrading to Allow for Temp. Loading **35,800 GSF on 2 Stories**

- Construction Area **98,600 GSF**
- Renovation Area
- Parking / Service Area
- New Construction

# Leamy Avenue Scheme PHASE 2

## Wellfield Installation and Site Preparation



# Leamy Avenue Scheme PHASE 3

## Construct Academic Support Wing



Construction of New Track & Field and Bleachers 14,300 GSF

Wellfield

Loading Access Maintained

Construction of New Academic Support Wing 102,600 GSF on 3 Stories

Construction of New Parking

- Construction Area 438,600 GSF
- New Construction
- Parking / Service Area



# Leamy Avenue Scheme PHASE 4

## Construct Academic Wing



- Academic Wings Remain in Use
- Demolition of H.S. Academic Support Spaces :  
Auditorium, P.E. Dining, and Arts 104,800 GSF on 2 Stories
- Temporary Utilities and Systems Remain in Operation
- Construction of Academic Wing 114,900 GSF on 3 Stories
- Completed Academic Support Wing
- Pedestrian Access Maintained between Existing and New

- Construction Area 207,200 GSF
- Renovation Area
- Renovation Completed
- New Construction



# Leamy Avenue Scheme PHASE 5

## Complete School Demolition



Demolition of Existing School 170,400 GSF on 2 Stories

Completed New High School in Operation

- Construction Area 311,600 GSF
- Renovation Area
- Renovation Completed



# Leamy Avenue Scheme PHASE 6

## Complete Site Improvements



Final Site Improvements : Fields and Parking

- Construction Area 330,500 GSF
- Renovation Completed



# Leamy Avenue Scheme

## Master Plan

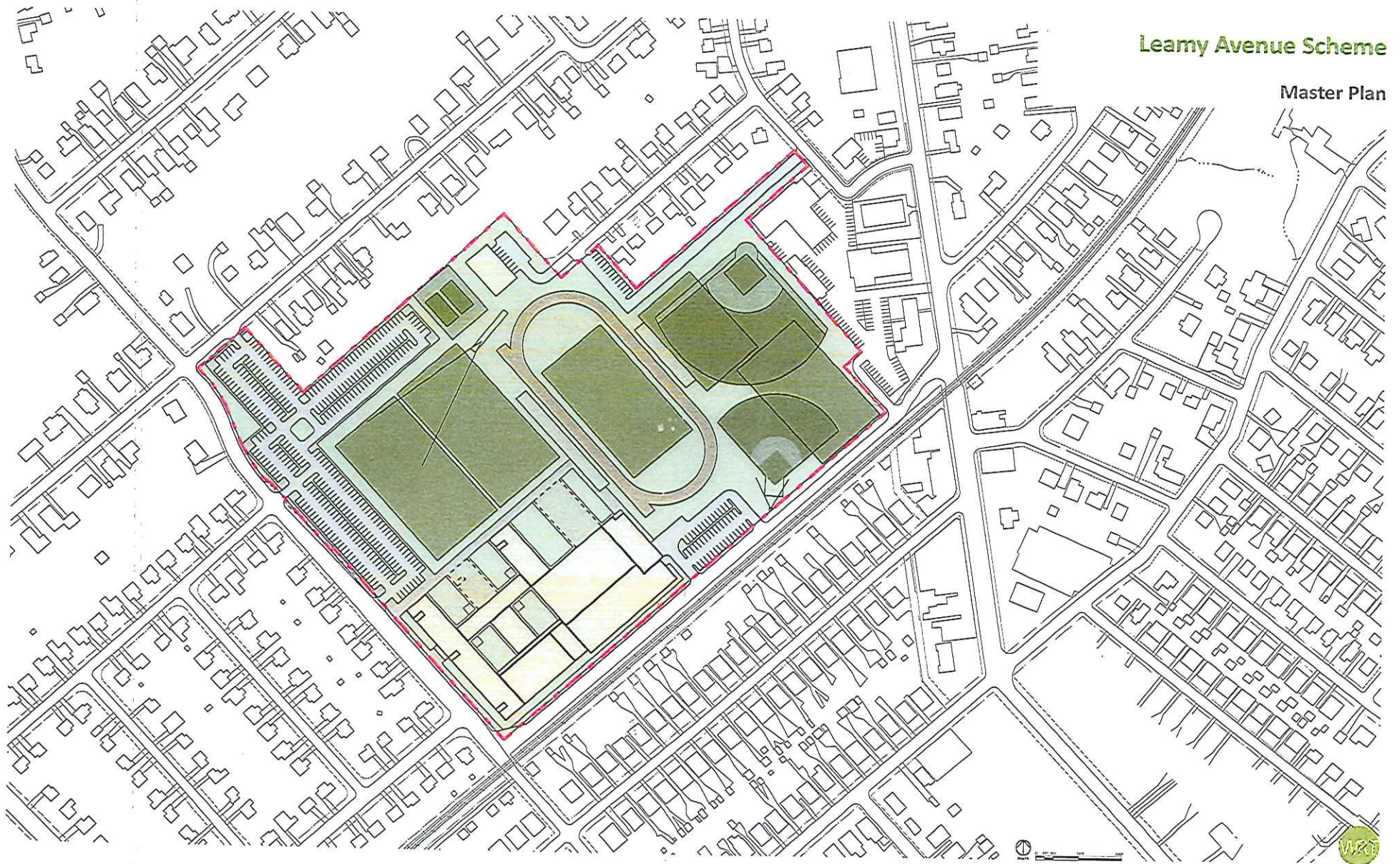



# Leamy Avenue Scheme

## Floor Plans

