

Springfield High School

Springfield School District
Delaware County - Pennsylvania

Master Plan Status Update

Presentation to Springfield School District

School Board Meeting / Executive Session- January 23, 2014

33

Outline

- Senior High School Projections / Education Goals
- Right Sizing the 'Box' / Program Goals
- Existing Facility
- Facility Master Plan Options
- Financing and Schedule
- Discussion



Senior High School Projections /
Education Goals

SPRINGFIELD PUBLIC ACADEMY

A new public post-secondary model for education
"Teach every student to LEARN"

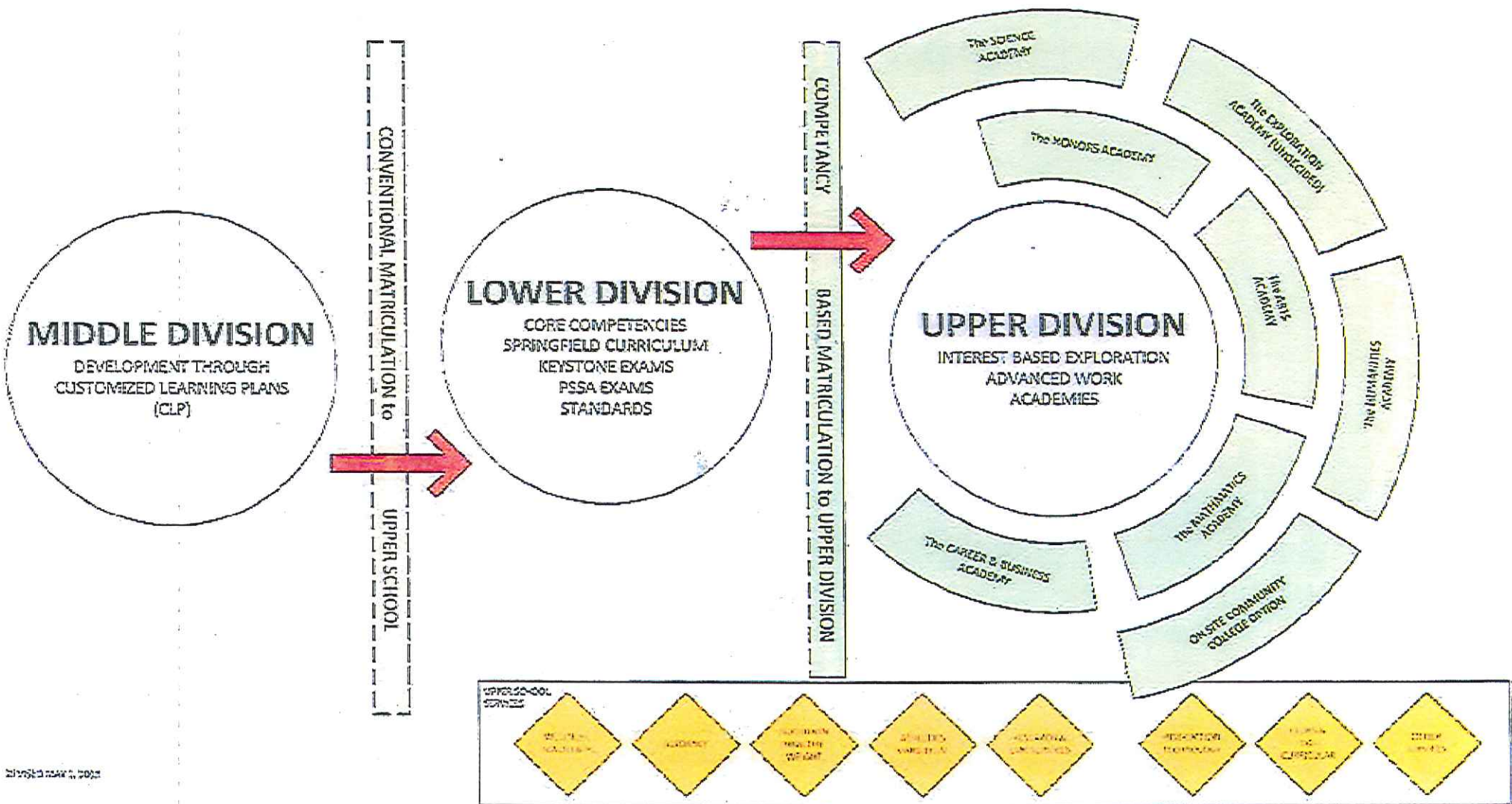

UPPER DIVISION

Onsite
College

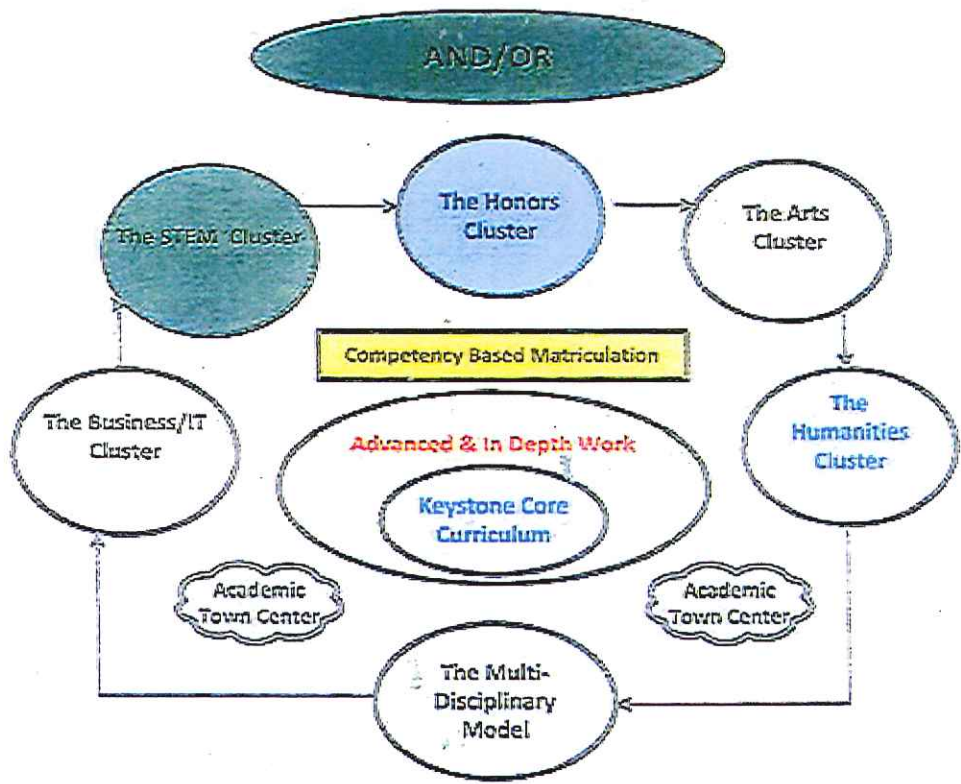

Year 4

An aerial photograph of a city grid, showing a central green park area. The text "Right Sizing the 'Box' / Program Goals" is overlaid in the center of the image.

Right Sizing the 'Box' / Program Goals

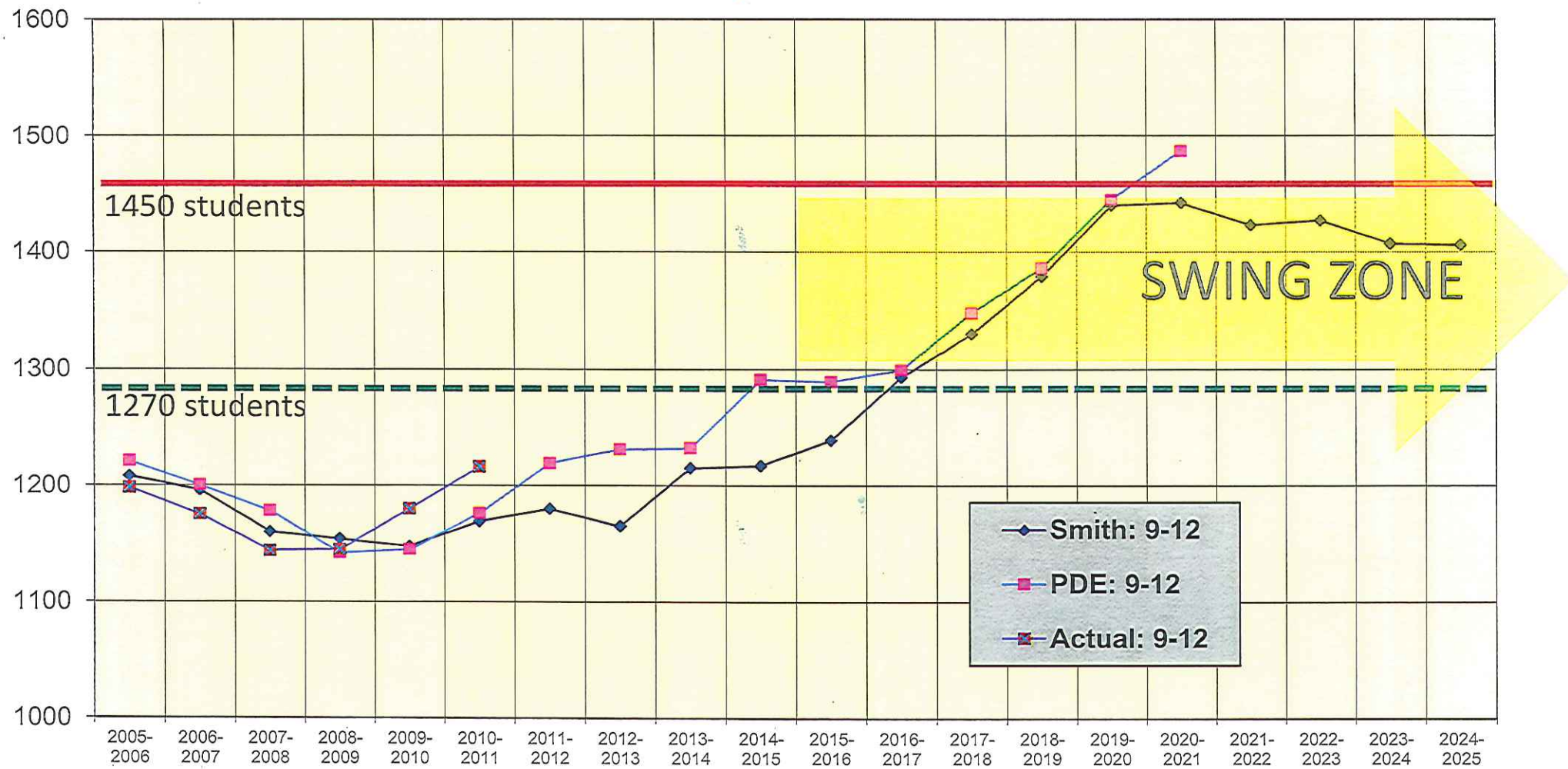

COMMITTEE CHARGE:

Assume maximum projection 1270 - expandable to 1450 students (implies 4400 total students)

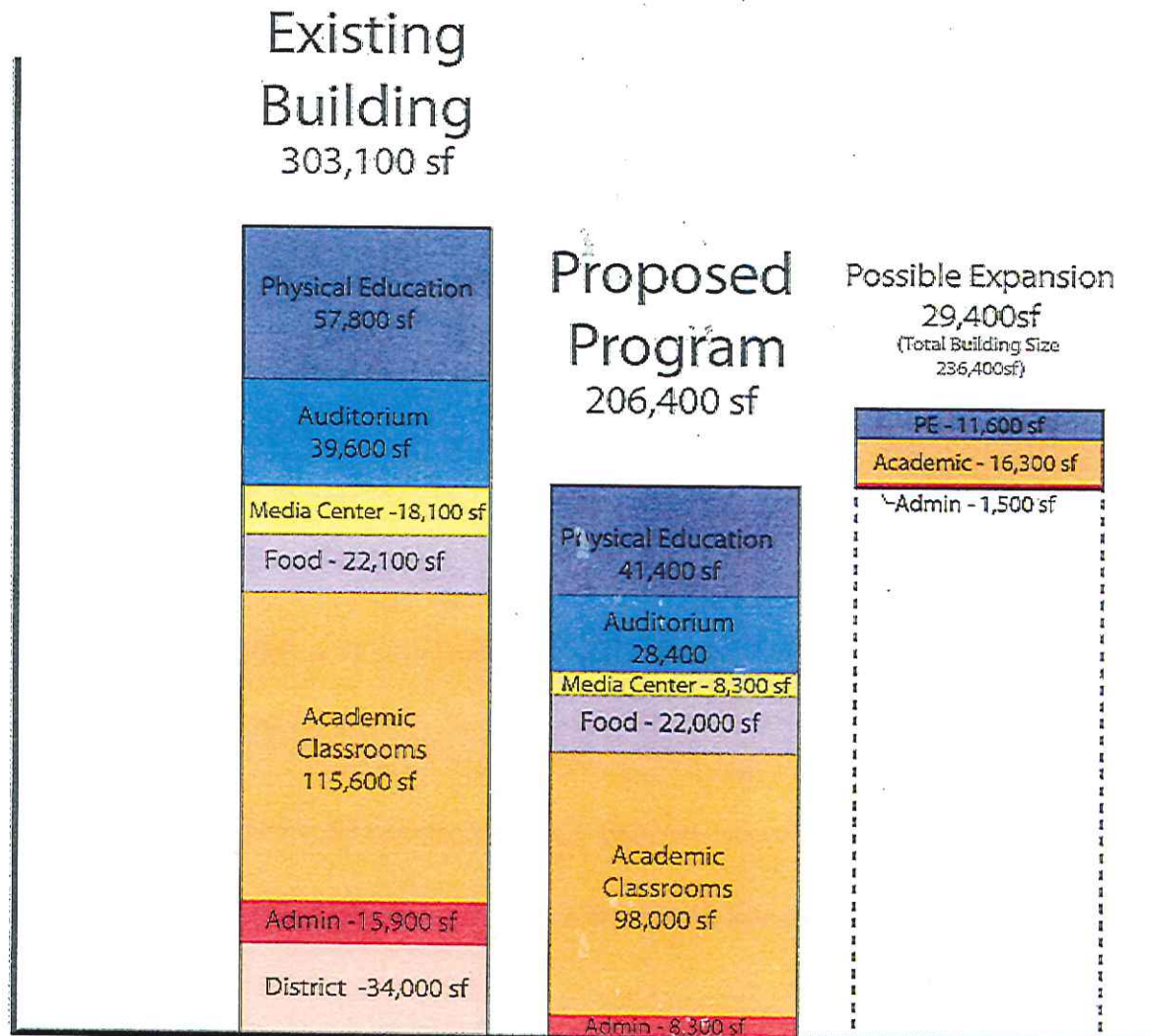

Proposed on June 26th, 2009

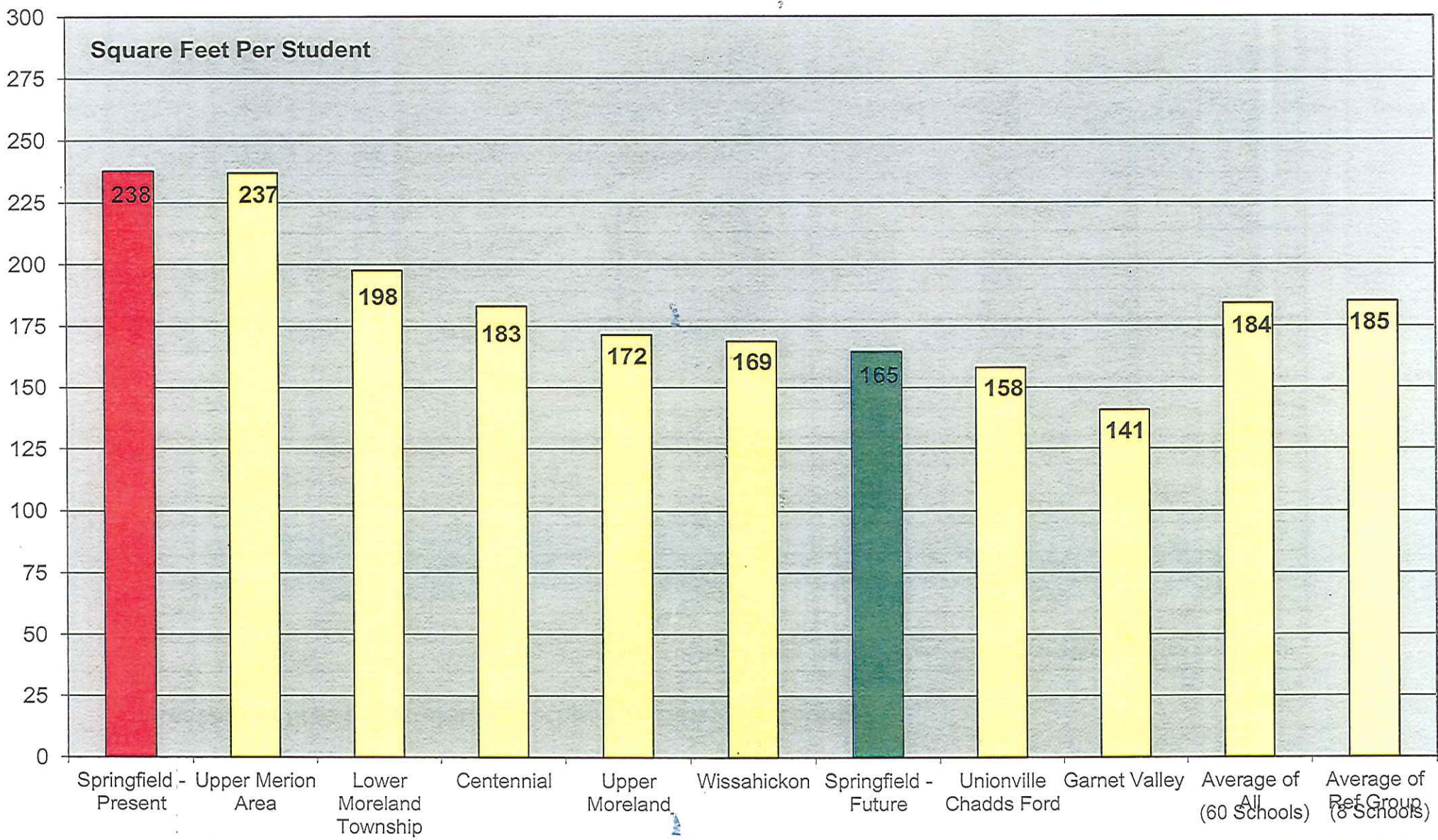

Analysis of area per student for schools in Delaware County

District	facilities supervisor	area of high school	Grade Levels	Current enrollment	Area Per student
Chester Upland	Kenneth Caulk				
Chichester	Jay Keever	224,000		1,296	172.84
Garnet Valley	Wade Brosius	267,422		1,529	174.90
Haverford Township	Robert Lester				
Interboro	George Wolhufe	98,000		1,171	83.69
Marple Newtown	Junior Guglielmi				
Penn Delco	Brian Datte	176,161	9,12	1,178	149.54
Radnor Township	Leo Bernabei	280,890	8,12	1,352	207.76
Ridley	Harry (Bud) Crouse				
Rose Tree Media	Ron Baldino	257,000	10,12	1,312	195.88
Southeast Delco	Harry Young	188,000		1,100	170.91
Upper Darby	Joseph Hughes	481,217		3,712	129.64
Wallingford Swarthmore	Jim Hardy				
William Penn	Dana Pinckney				
Springfield		270,547		1,267	213.53

Based on district provided information and current enrollment

School Property
1,059,100 sf - 24 Acres

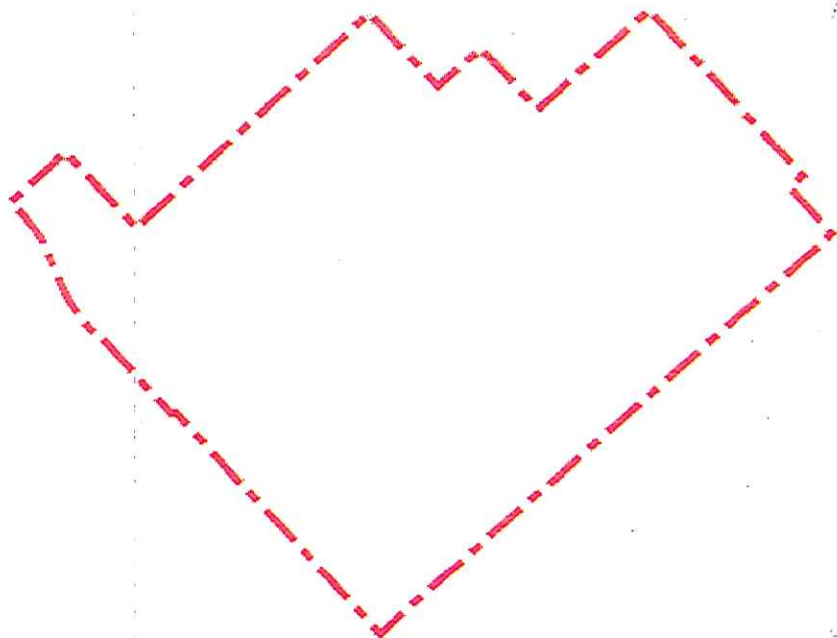

Athletic Fields

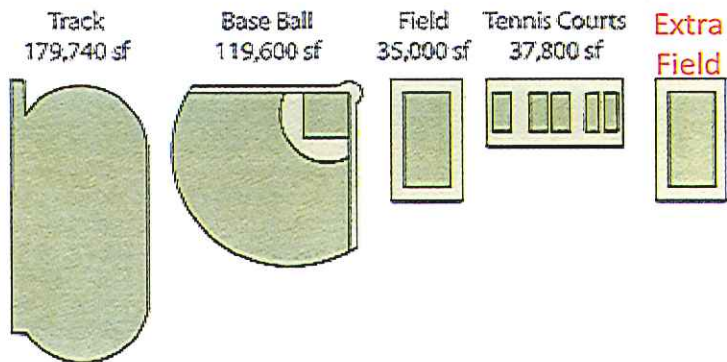

Building

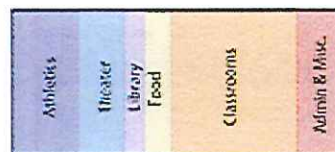

Parking



Existing Facility

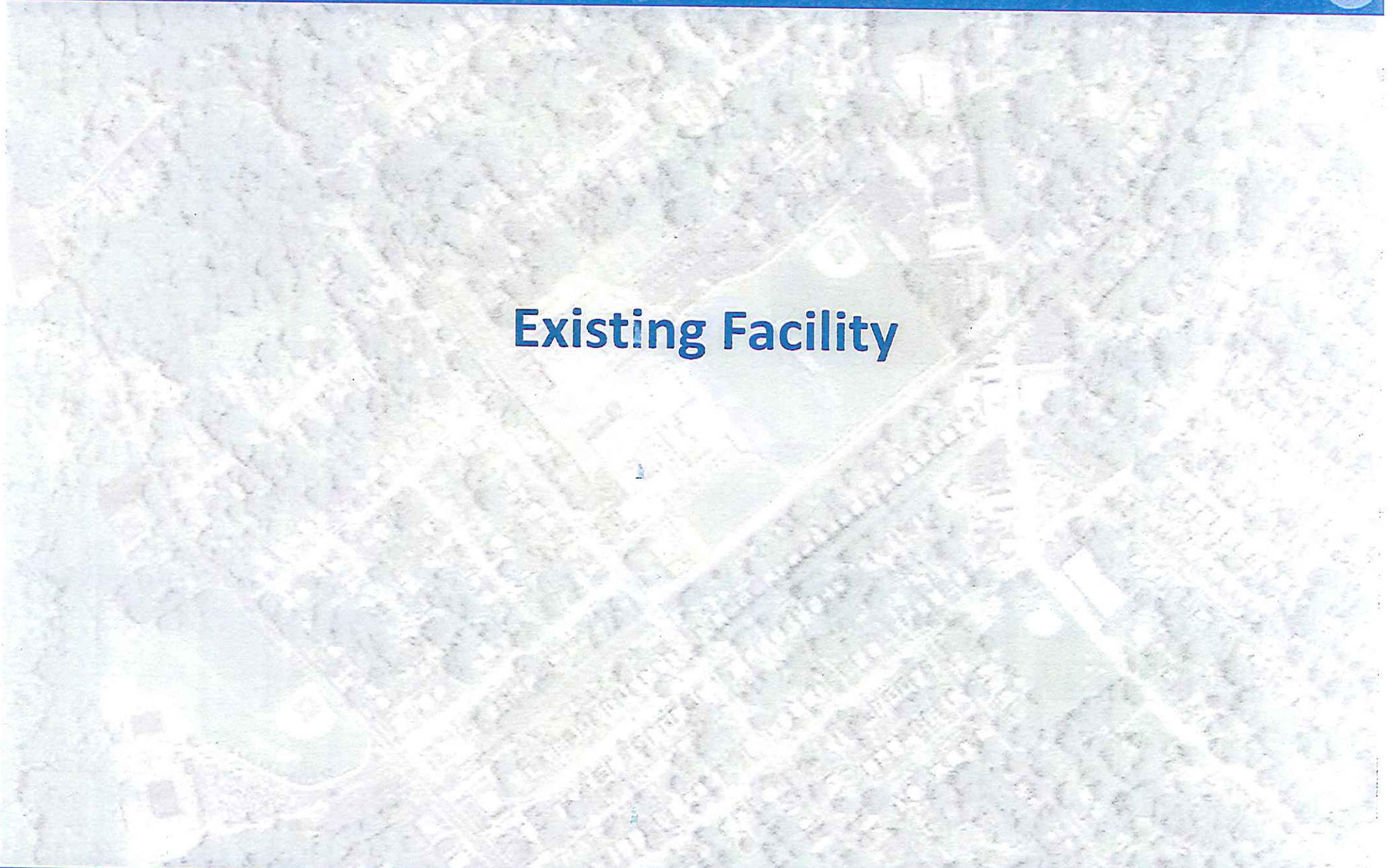



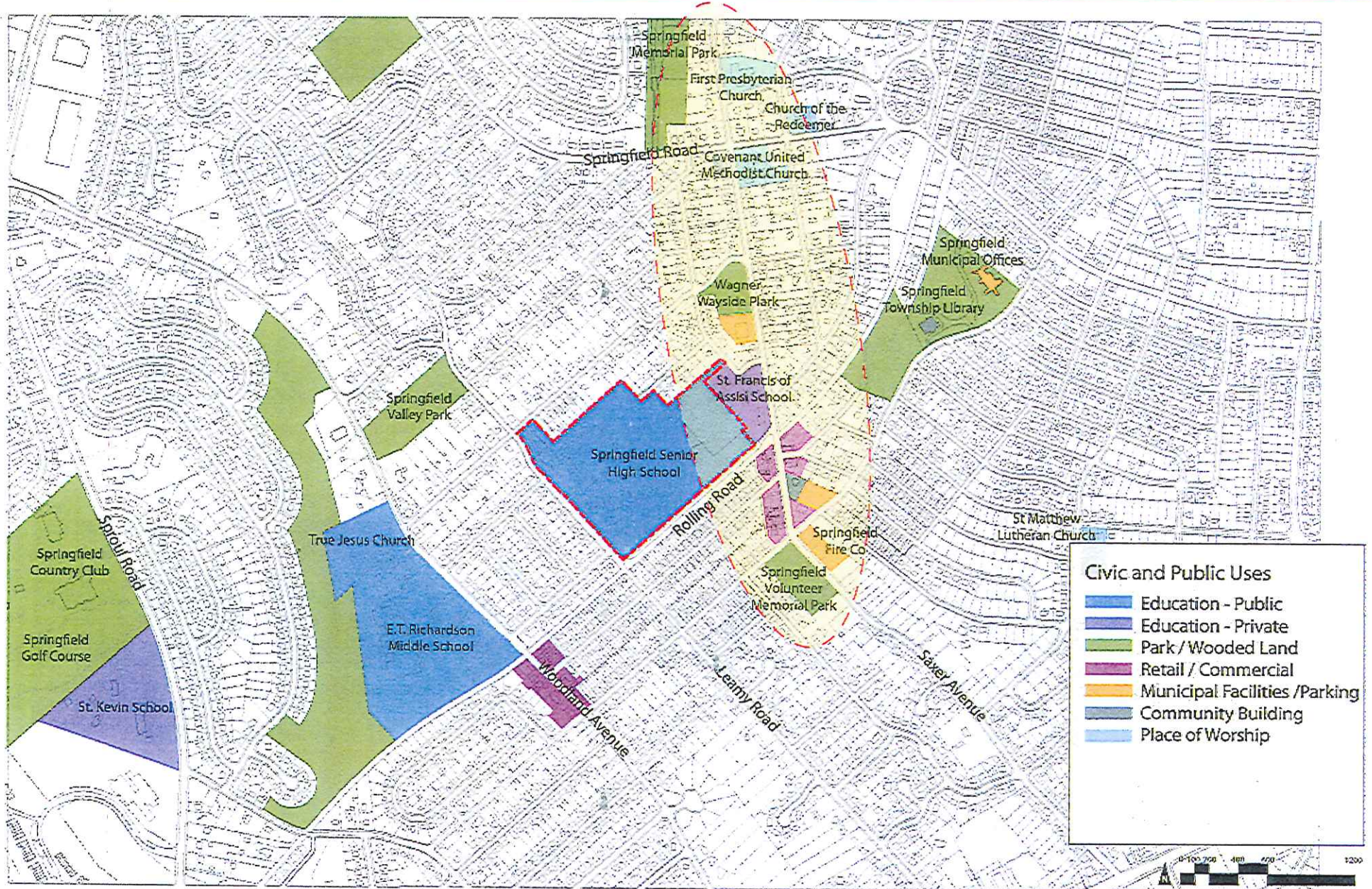

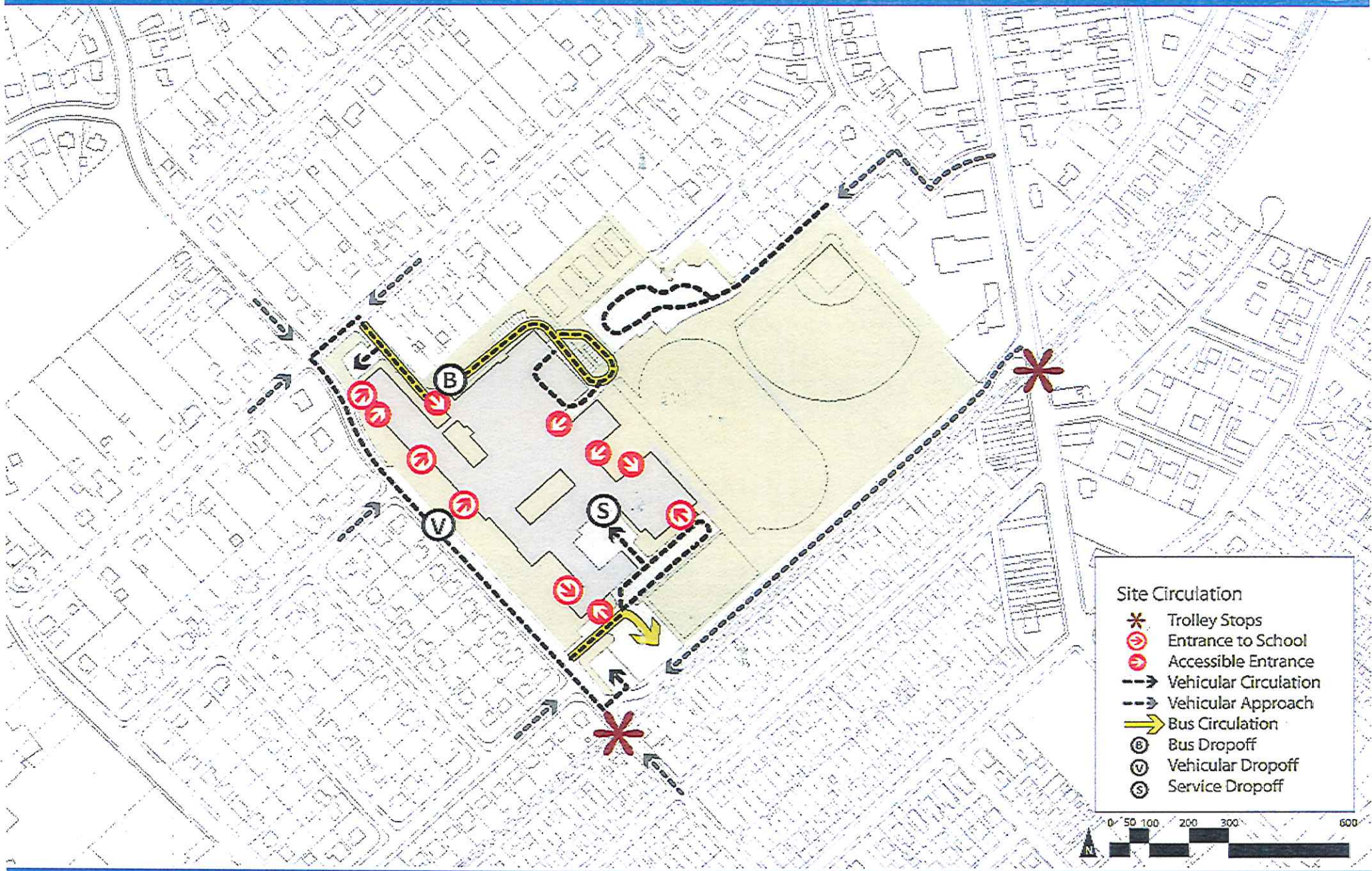

Site Circulation

- * Trolley Stops
- Ⓢ Entrance to School
- ♿ Accessible Entrance
- - - Vehicular Circulation
- - - Vehicular Approach
- Bus Circulation
- Ⓟ Bus Dropoff
- Ⓥ Vehicular Dropoff
- Ⓢ Service Dropoff

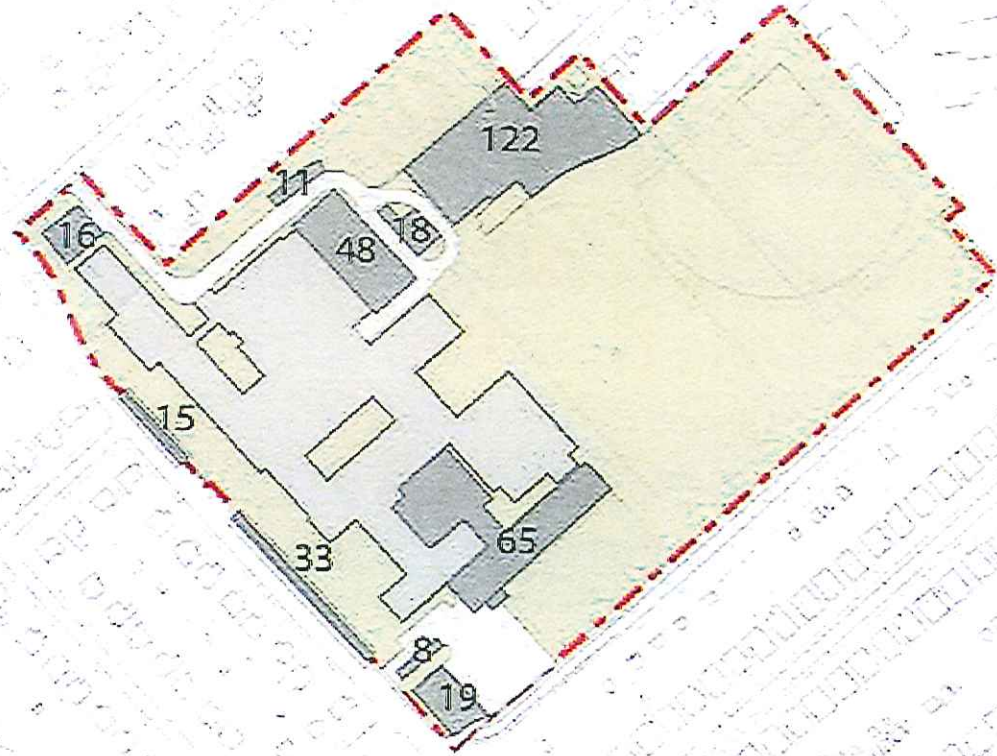

Parking

- Designated Parking
- On-street Parking

Parking on Campus — 360
Public Parking within 1/4 mile — 320
Total parking — 680

Parking Required by Code:
1 space for each faculty member and full time employee
+
2 spaces for each classroom
+
1 space for every 12 students over the age of 16

0 50 100 200 300 600

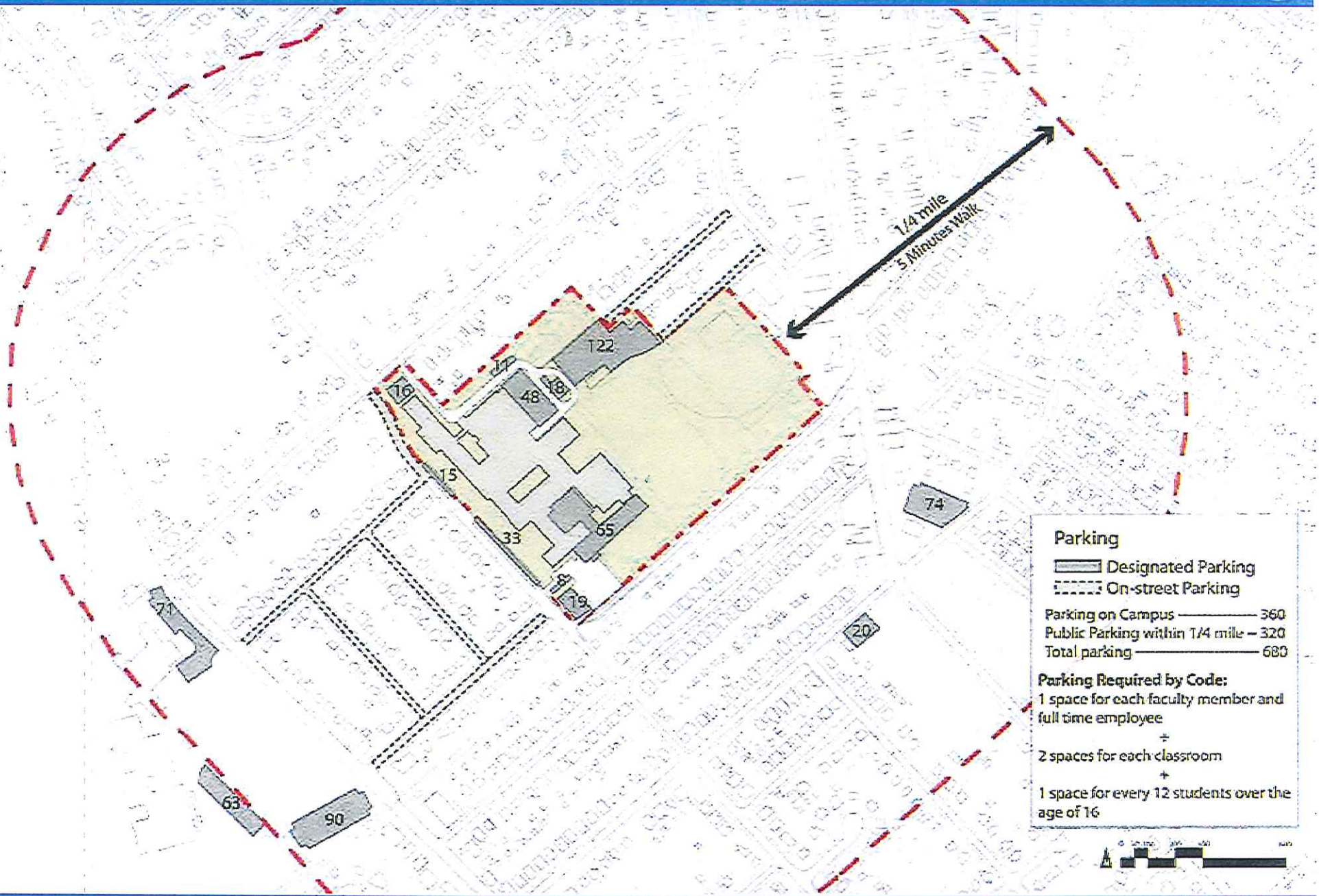

Parking

- Designated Parking
- On-street Parking

Parking on Campus ————— 360
 Public Parking within 1/4 mile — 320
 Total parking ————— 680

Parking Required by Code:
 1 space for each faculty member and full time employee
 +
 2 spaces for each classroom
 +
 1 space for every 12 students over the age of 16

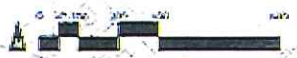

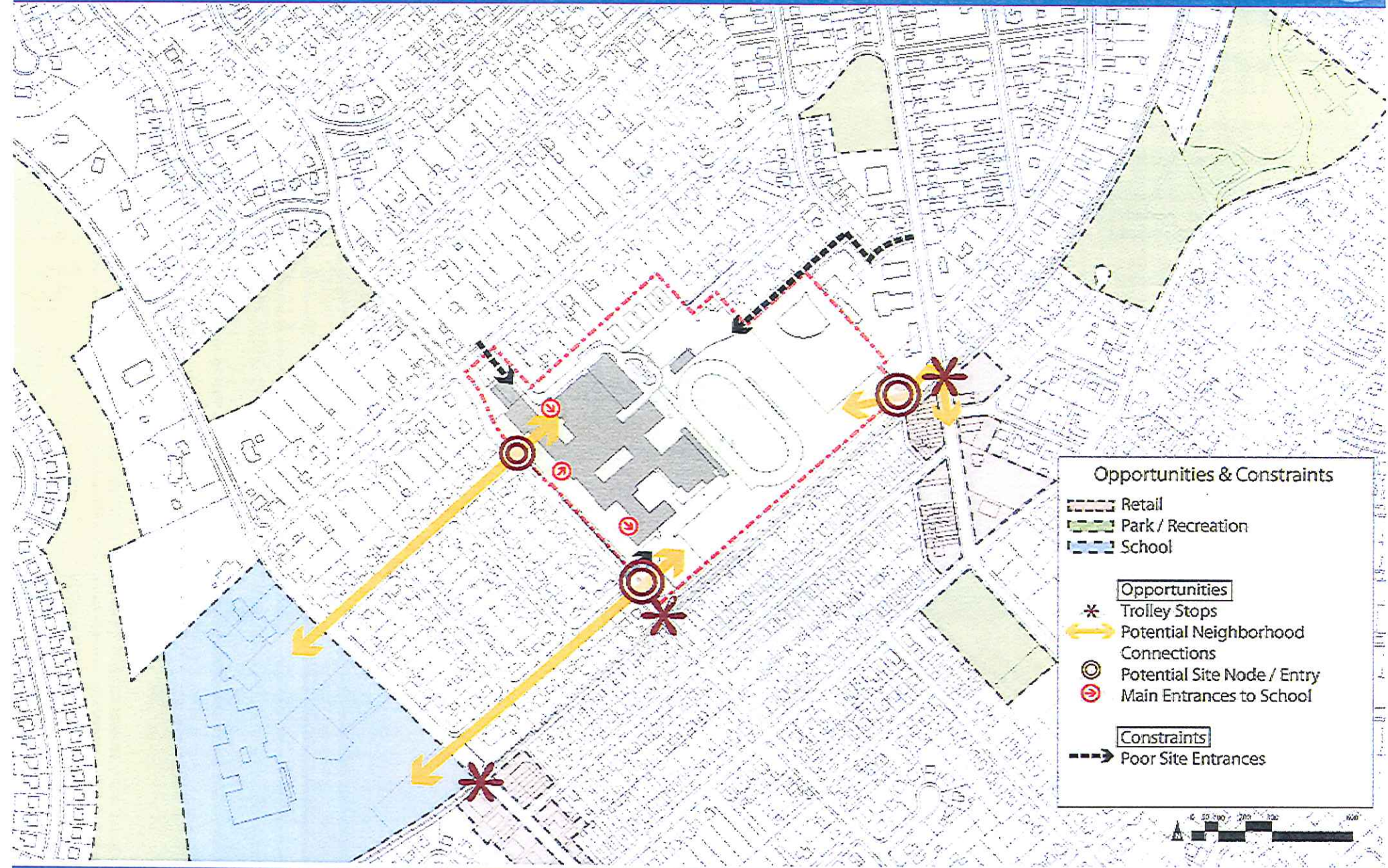

Campus Edges

Connections

Construction Limits

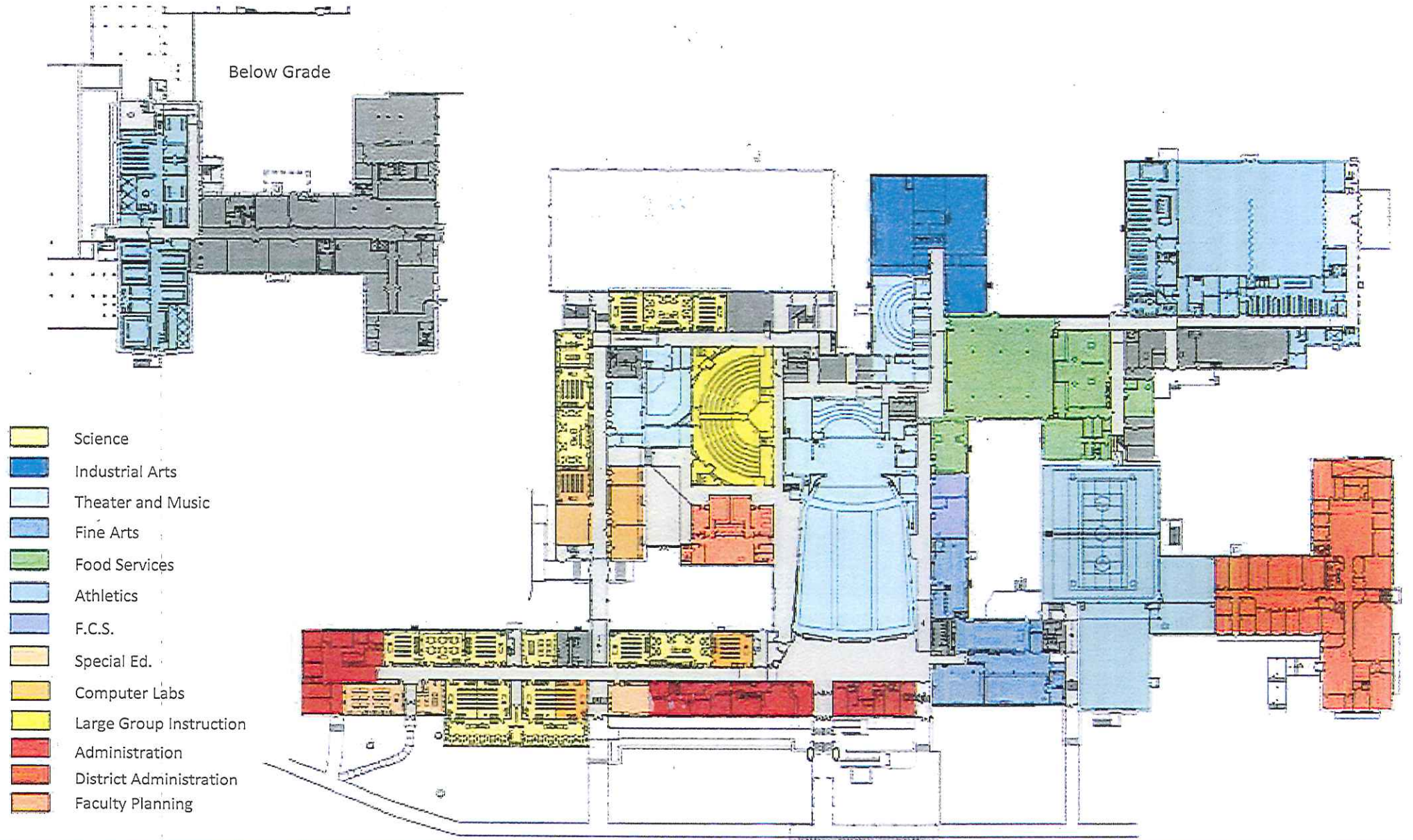

Guiding Principles

- Create the **optimal learning environment** for education
- Strengthen **connections** to the broader community
- Promote the use of the School as a place for the community :
Town Center
- Create a **sustainable** School that deploys the best in high performance building design to reduce energy consumption and promote classroom achievement.

Site/Campus Goals

- Improve **circulation** and connections to school.
- Add **athletic fields** and improve their quality.
- Increase **parking capacity** of campus without impacting goals for athletic program.
- **Minimize vehicular circulation** within the campus.
- Promote **walking** and public transit.
- Increase amount of community **green space**.

Facility Master Plan Options

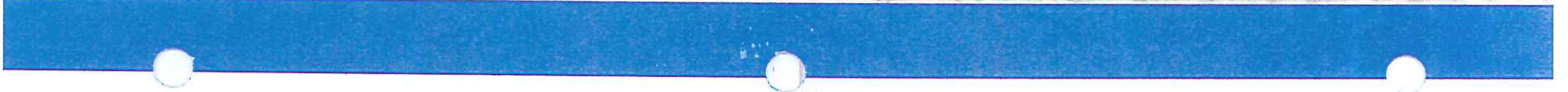

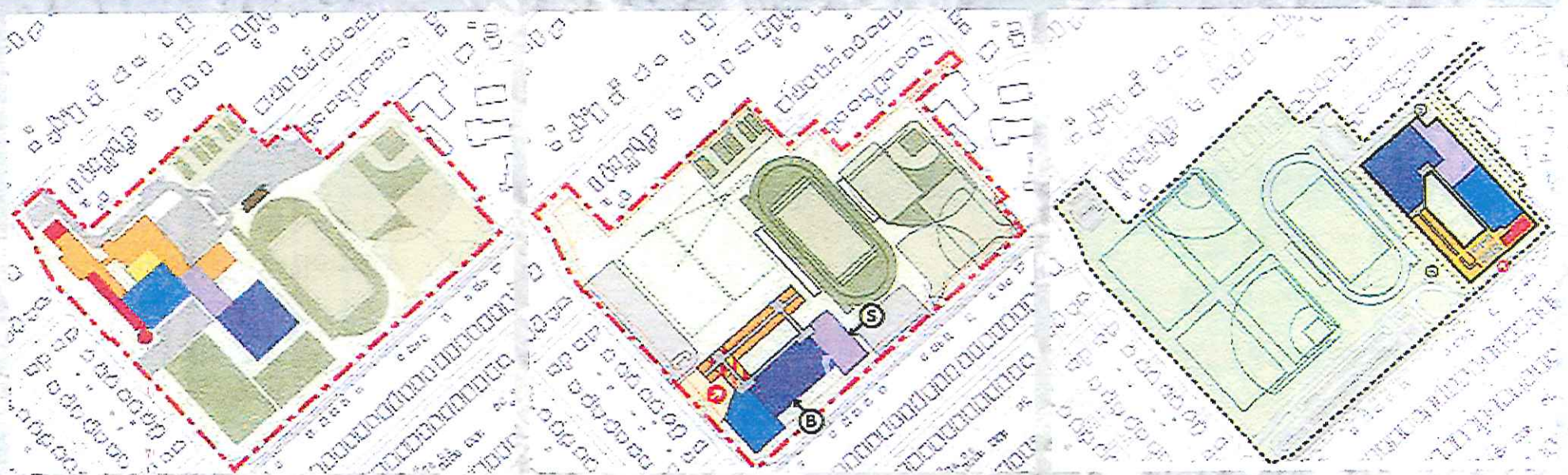

Three Options Compared

Detailed Review for Phasing / Cost

- Existing Building – (Service Life Extension)
- Leamy Ave. New Building
- Saxer Ave. New Building

KEY SCOPE ITEMS

- Reduction of building size; consolidation of program components.
- Relocation of District Office and Bus Parking
- Building Performance and design upgrades :
 - Hazmat removal
 - Life-safety
 - Energy performance
 - Building Systems
 - Accessibility
- Building Design / Identity

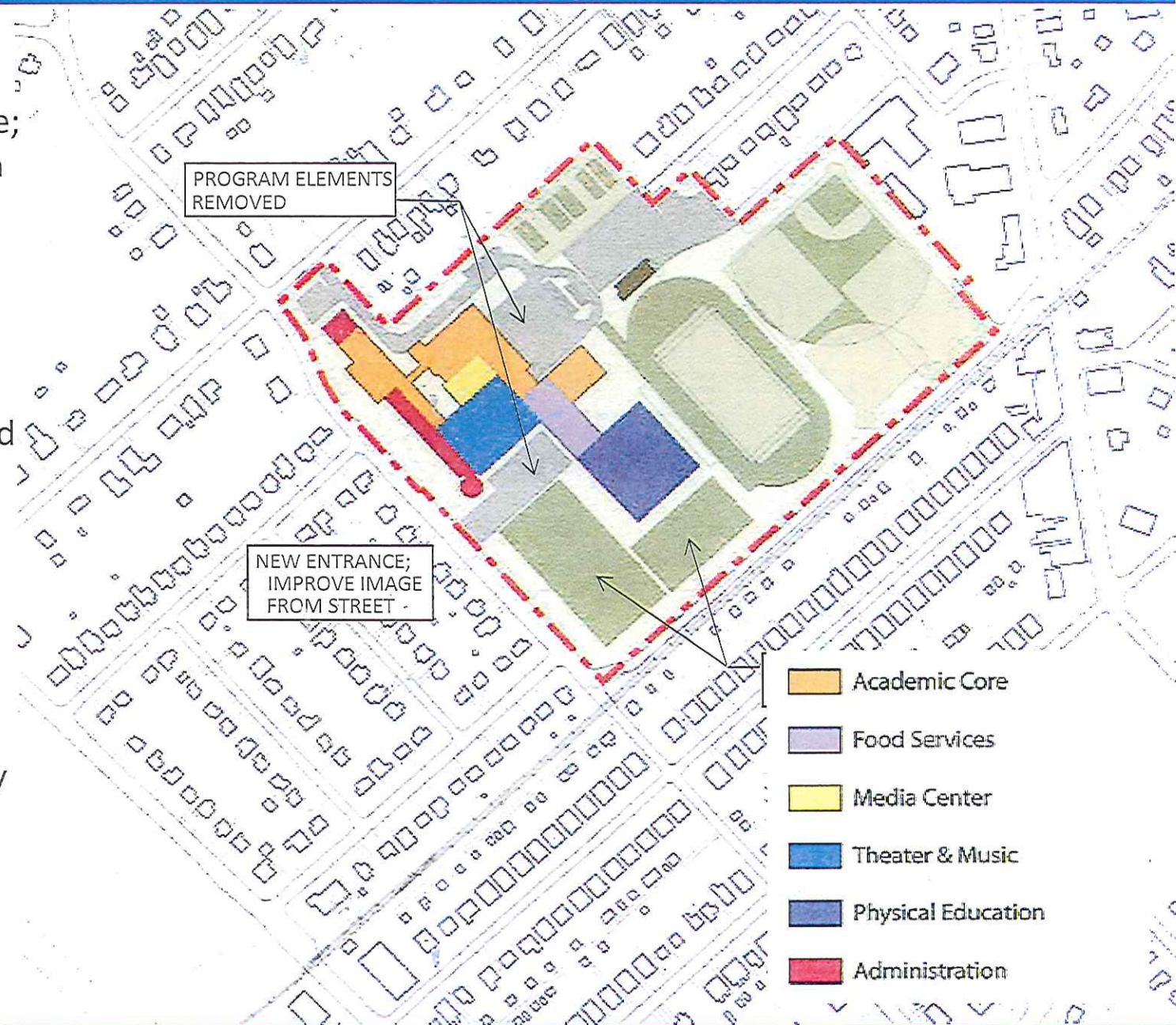

PHASING CHALLENGES

- Remediation of Roof Deck and building envelope: exposure to elements.
- Building Systems: service interruptions
- Significant Building Renovation scope:
 - Cannot to be completed within Summer periods
 - Construction Phasing Schedule long and complex

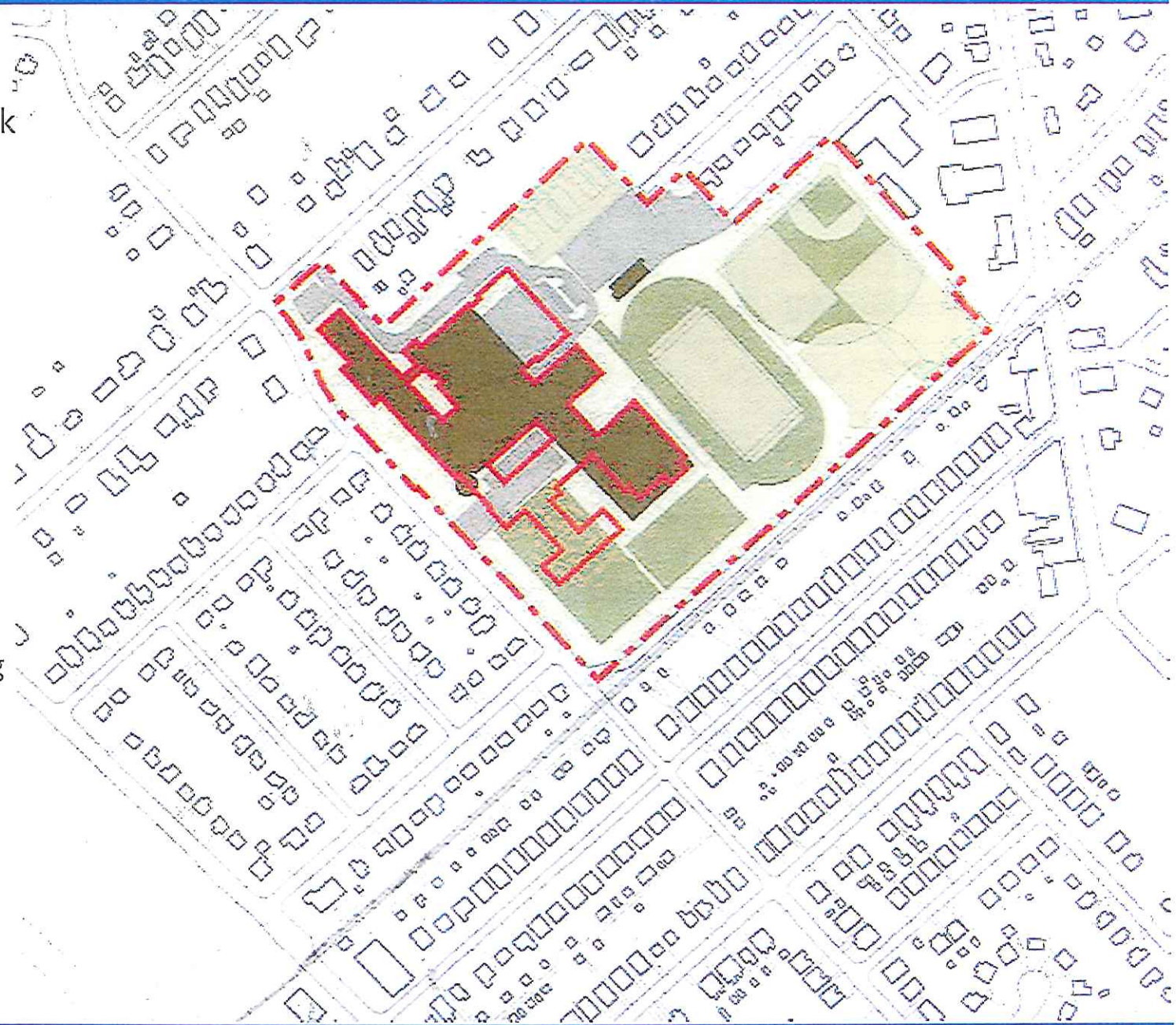

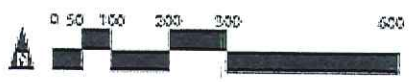
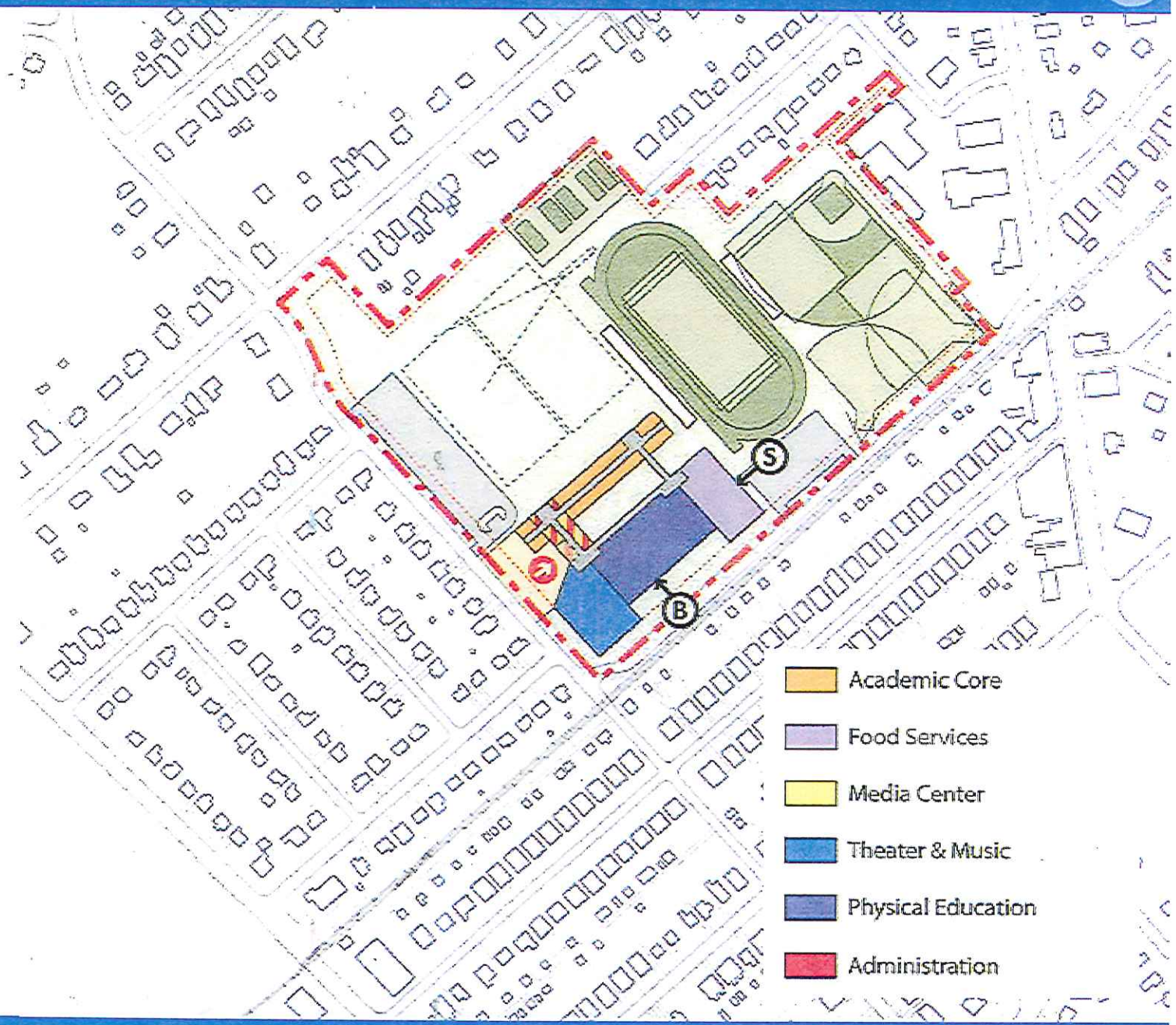

PHASING CHALLENGES

- Building Systems :
service interruptions
(location of existing plant
and utilities)
- Significant Overlap of
Existing Building with
Proposed Building:
 - Complex Construction
Phasing

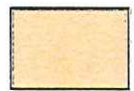

EXISTING HIGH SCHOOL



NEW BUILDING FOOTPRINT



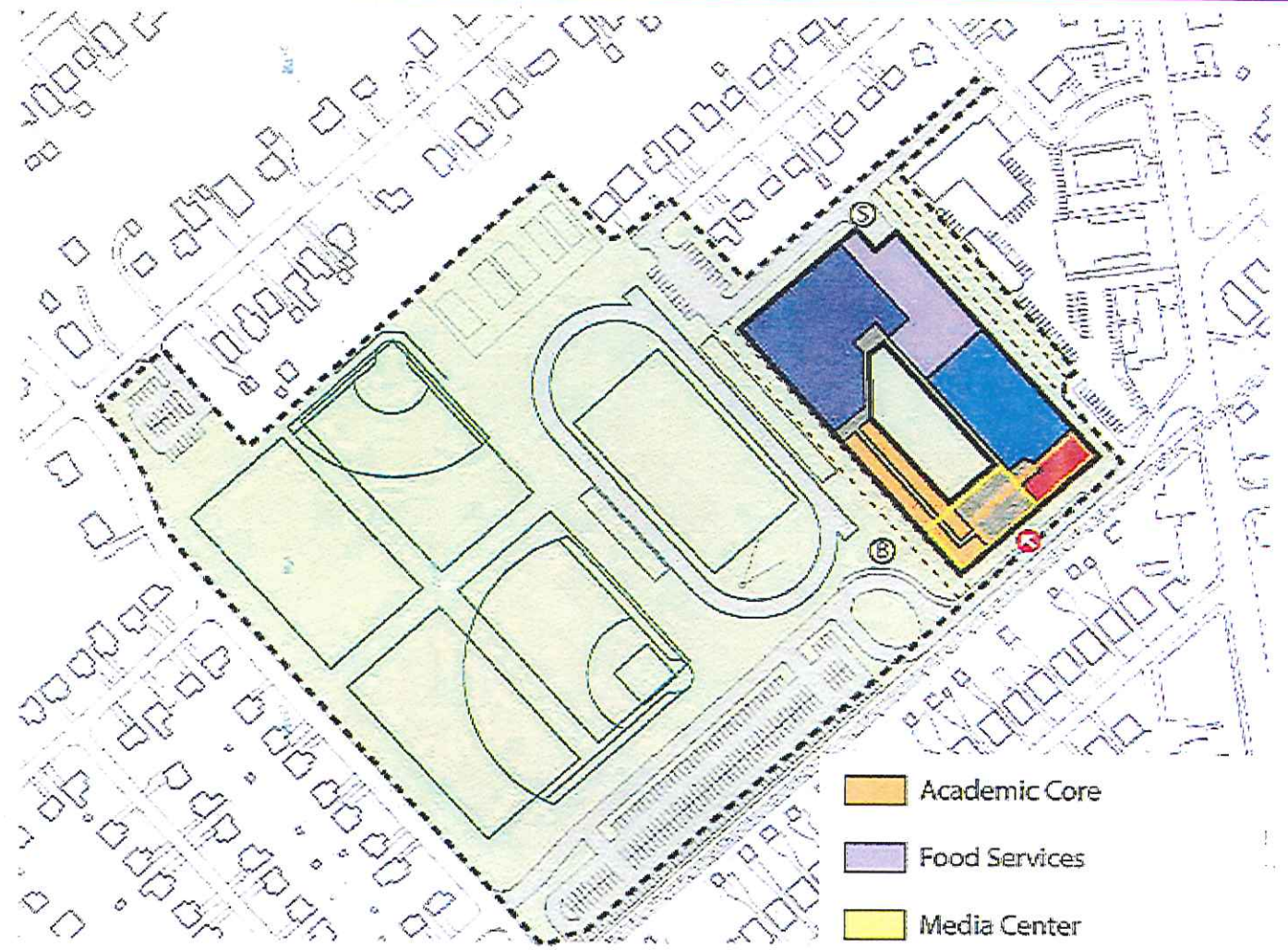

- Academic Core
- Food Services
- Media Center
- Theater & Music
- Physical Education
- Administration



SAXER AVENUE SITE

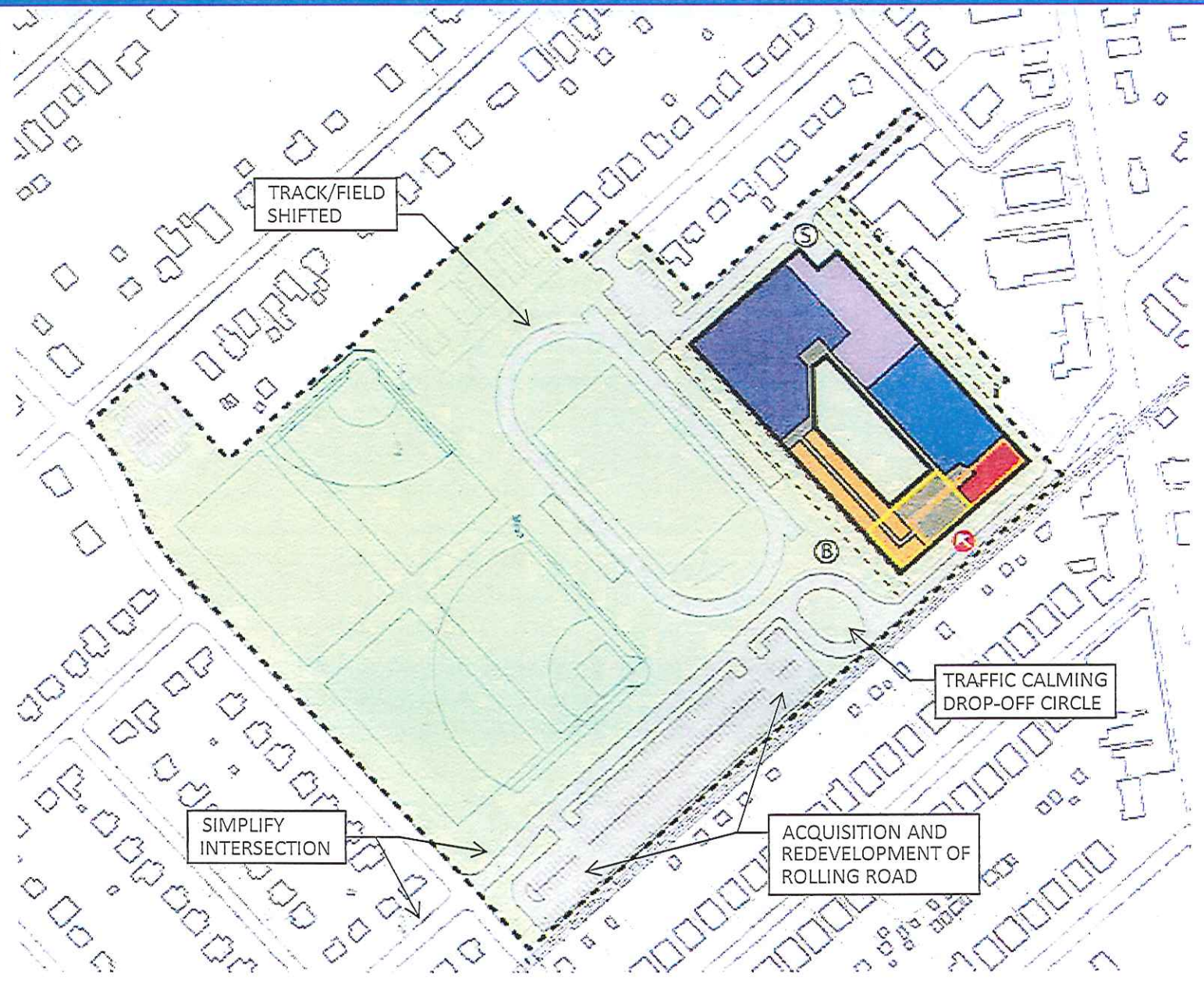

PHASING OPPORTUNITIES

- New School can be developed while Existing School remains fully operational
- Track and Field can be relocated prior to any other work; only rear parking would be displaced
- Geothermal Wellfield : under track or parking

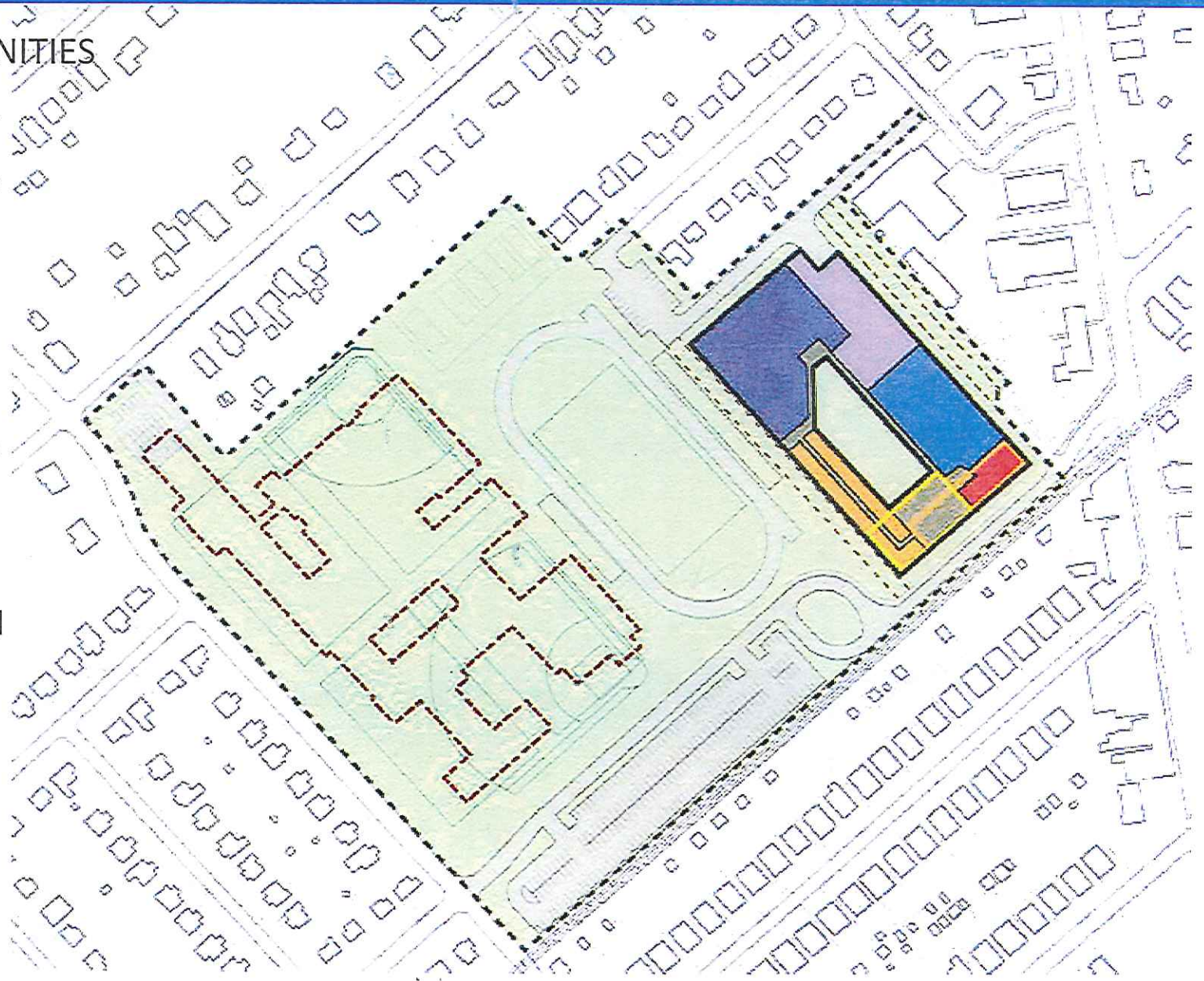

SAXER AVENUE SITE

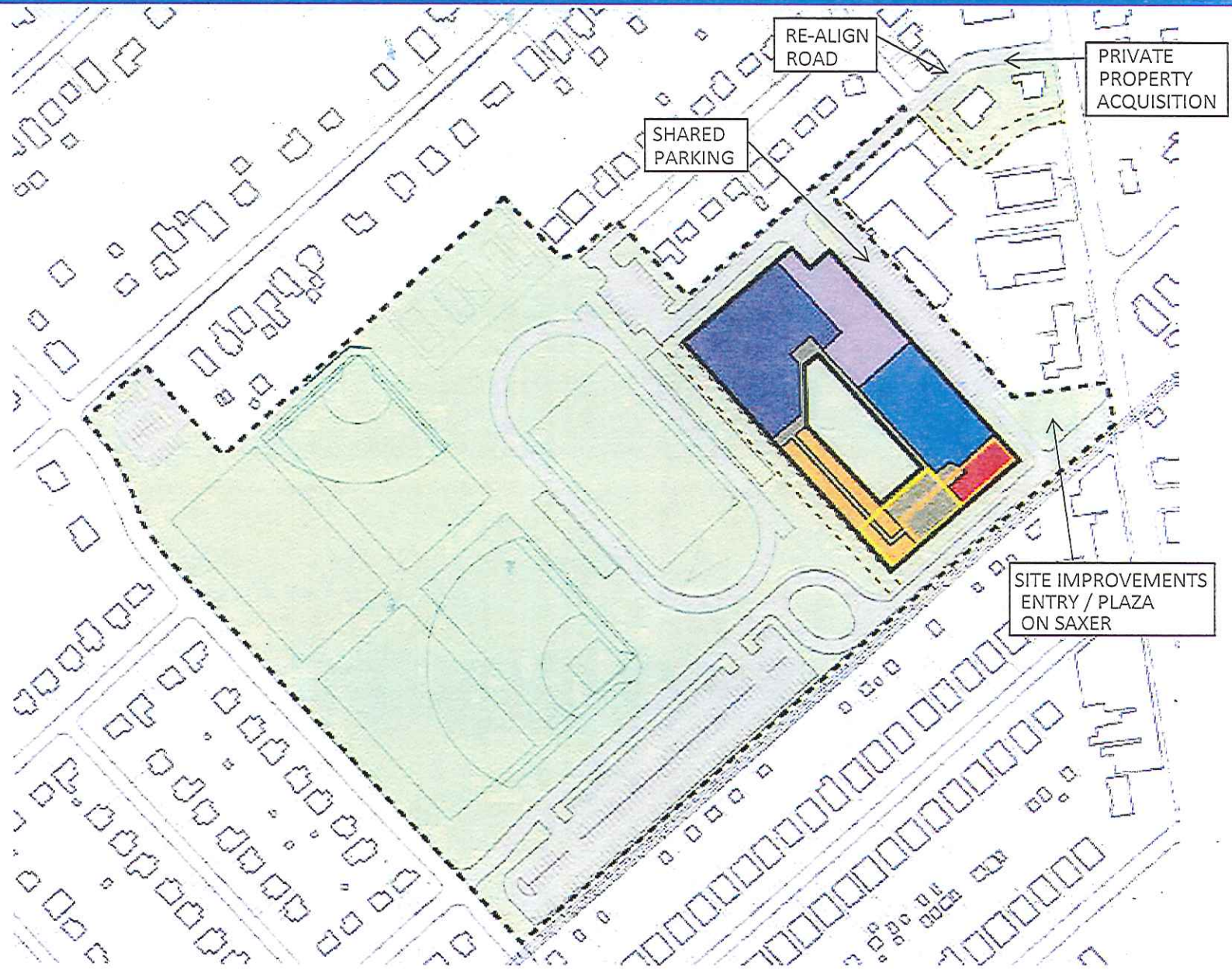

Renovation vs. New Construction

Maintain / Upgrade Existing vs. New Educational Opportunities



1
2
3
4
5
6
7
8
9
10
11
12
13
14
15
16
17
18
19
20
21
22
23
24
25
26
27
28
29
30
31
32
33
34
35
36
37
38
39
40
41
42
43
44
45
46
47
48
49
50
51
52
53
54
55
56
57
58
59
60
61
62
63
64
65
66
67
68
69
70
71
72
73
74
75
76
77
78
79
80
81
82
83
84
85
86
87
88
89
90
91
92
93
94
95
96
97
98
99
100

101

102

103

104

105

106

107

108

109

110

Three Options Compared

Detailed Review for Phasing / Process

- Existing Building – Service Life Extension
- Leamy Ave. Site
- Saxer Ave. Site

KEY SCOPE ITEMS

- Reduction of building size; consolidation of program components.
- Relocation of District Office and Bus Parking
- Building Performance and design upgrades :
 - Hazmat removal
 - Life-safety
 - Energy performance
 - Building Systems
 - Accessibility
- Building Design / Identity

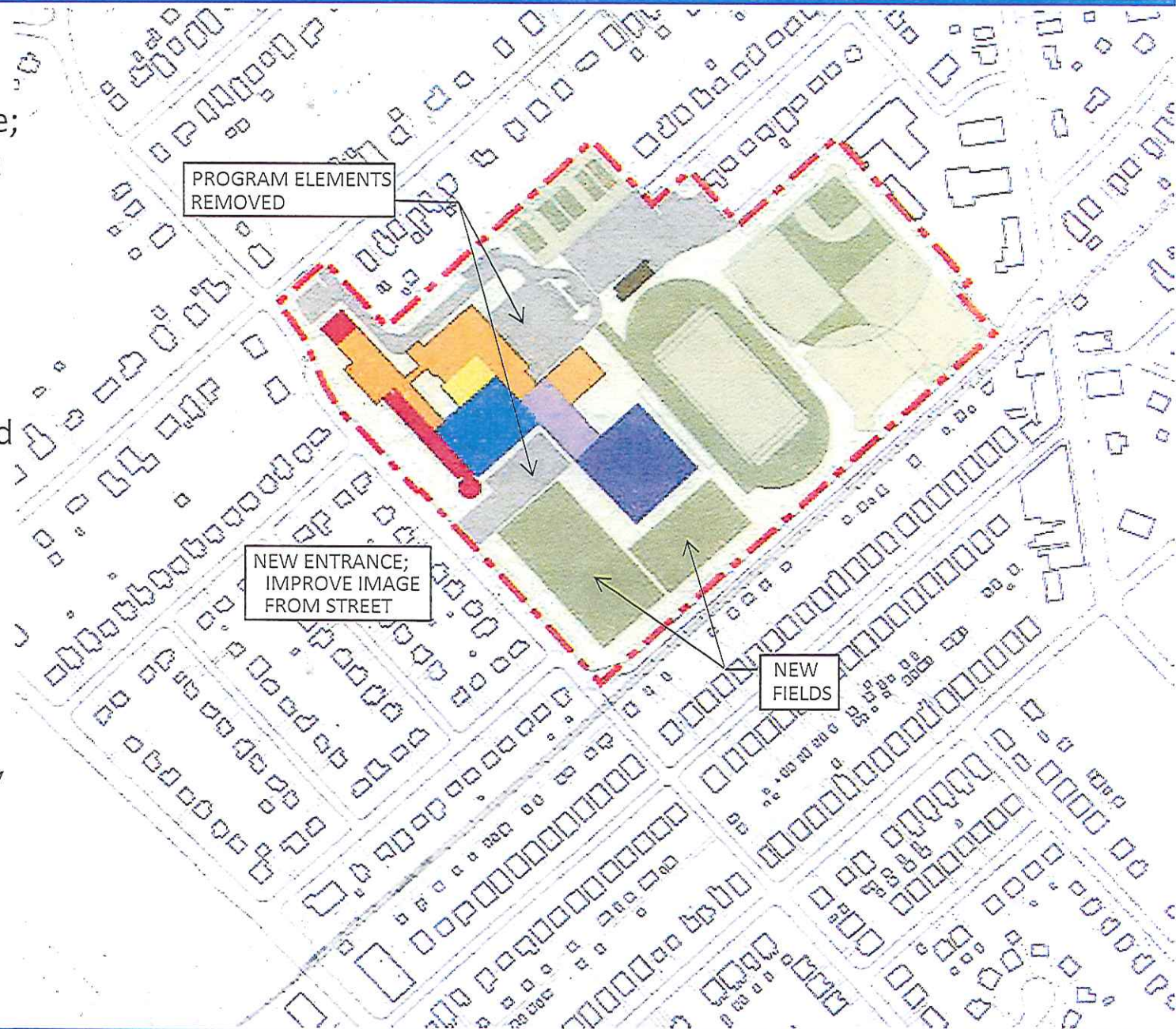



PHASING CHALLENGES

- Remediation of Roof Deck and building envelope : exposure to elements.
- Building Systems : service interruptions
- Significant Building Renovation scope :
 - Cannot to be completed within Summer periods
 - Construction Phasing Schedule long and complex







LEAMY AVENUE SITE

-  EXISTING HIGH SCHOOL
-  NEW BUILDING FOOTPRINT

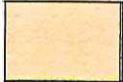
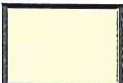

LEAMY AVENUE SITE
 PHASE 1A - PREPARE FOR NEW CONSTRUCTION

-  EXISTING HIGH SCHOOL
-  CONSTRUCTION ZONE
-  BUILDINGS & SITE FEATURES TO TO BE DEMOLISHED
-  UTILITIES REMOVED
-  NEW UTILITIES

NOTES:

CREATE TEMPORARY CENTRAL PLANT AT AUXILARY GYM

- DEMOLITION/ RELOCATION WORK
- EXISTING SCHOOL DISTRICT OFFICES
 -RELOCATE IT/NETWORK HUB
 - DEMO PORTION OF BLUE GYM
 - TRACK & PORTION OF BLEACHERS

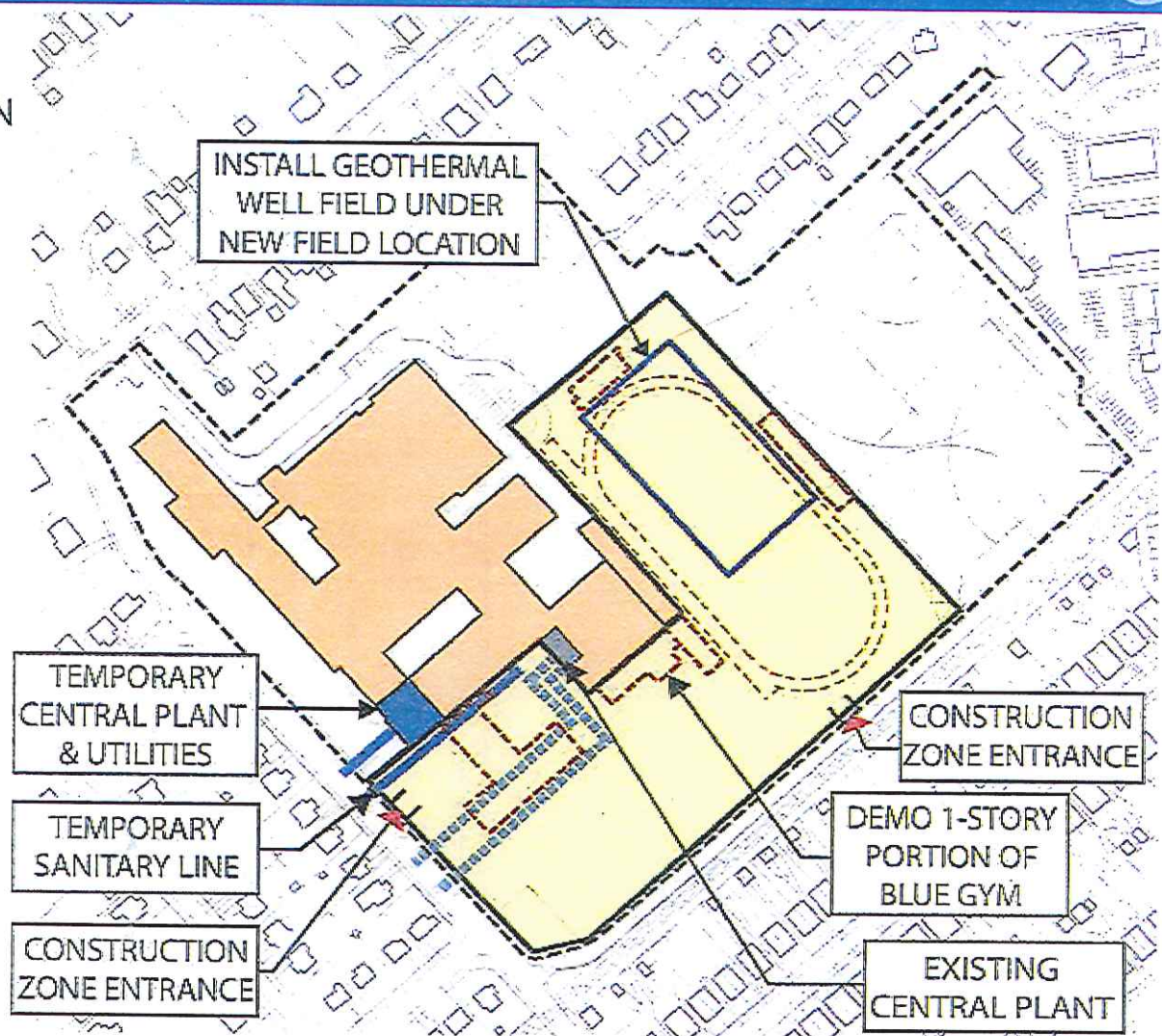

LEAMY AVENUE SITE
 PHASE 1B -
 CONSTRUCTION OF "BIG BOX" ELEMENTS
 (THEATER, GYM, & CAFETERIA)

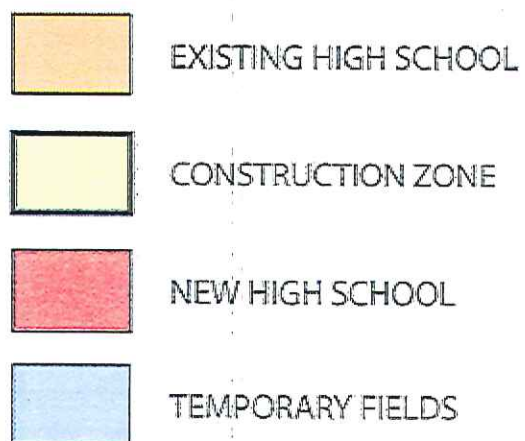



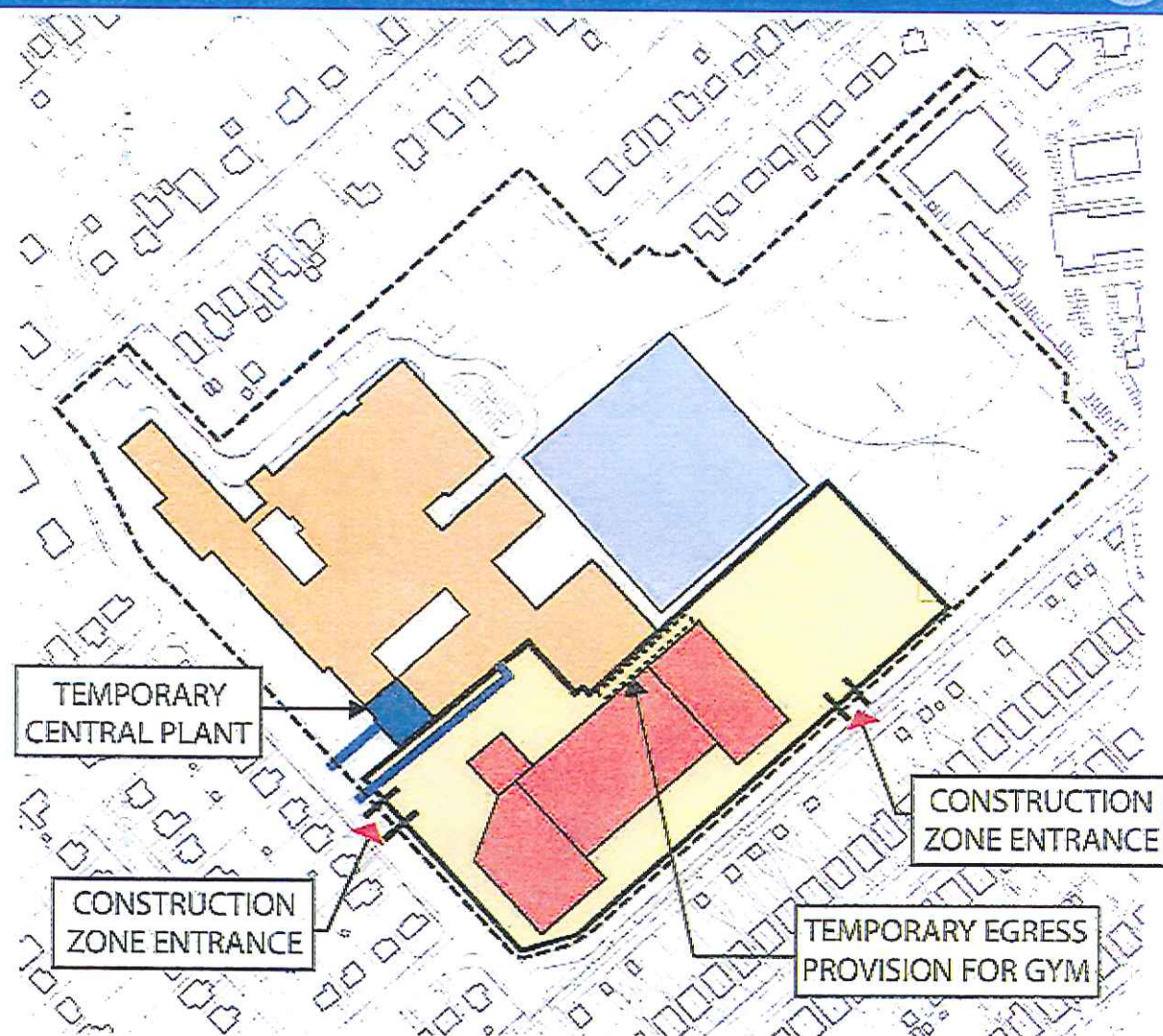

NOTES:

BEGIN CONSTRUCTION OF NEW HIGH SCHOOL
 ("BIG BOX" PROGRAM ELEMENTS)



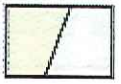
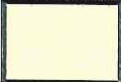

LEAMY AVENUE SITE PHASE 2 CONSTRUCTION OF ACADEMIC WING

-  EXISTING HIGH SCHOOL ACADEMIC PROGRAM
-  DEMOLITION OF REDUNDANT PROGRAMING (SUMMER WORK)
-  NEW HIGH SCHOOL COMPLETED PHASE
-  NEW HIGH SCHOOL CONSTRUCTION
-  NEW SITE IMPROVEMENTS TRACK & PARKING (SUMMER WORK)
-  CONSTRUCTION ZONE

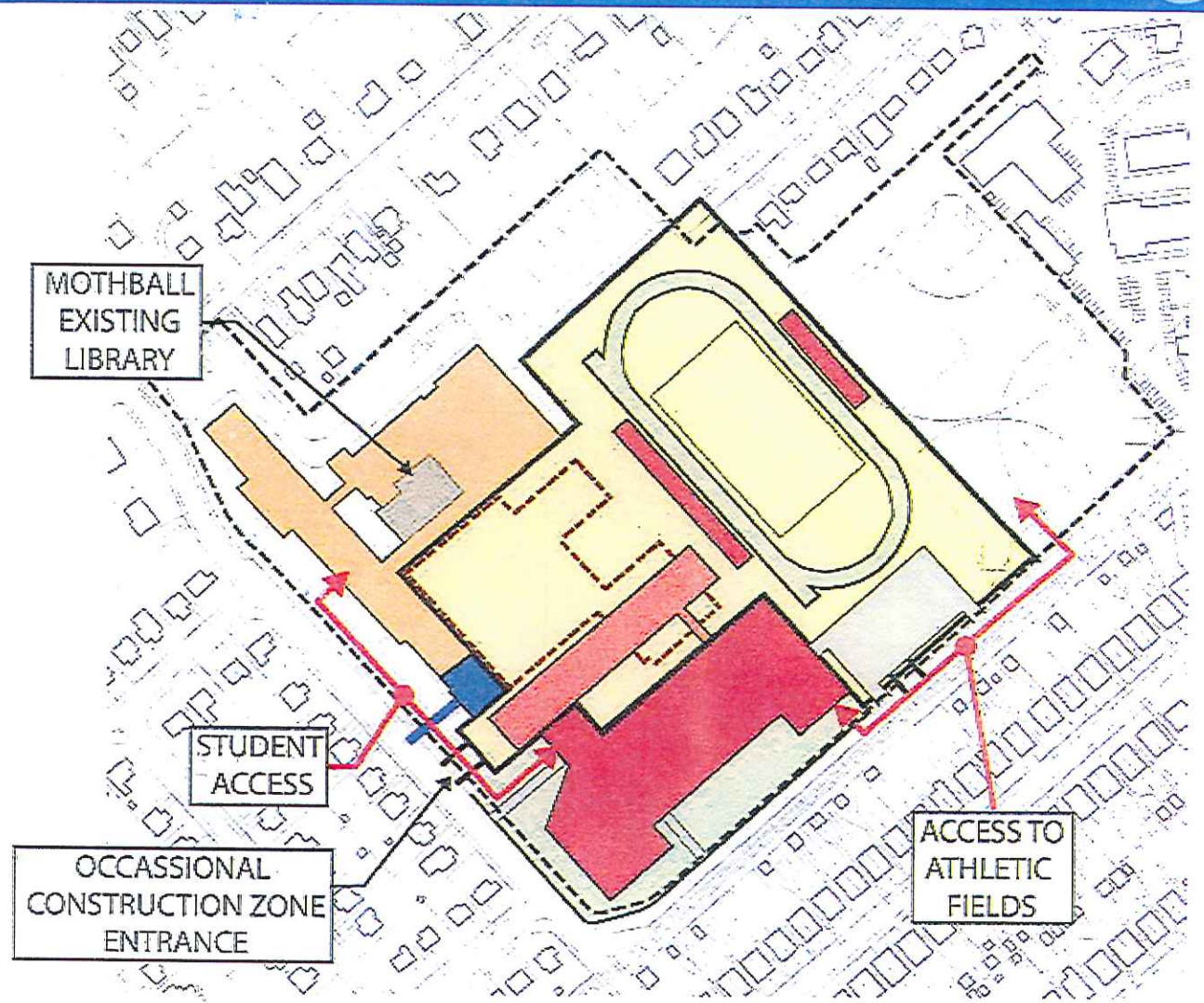
NOTES:
 CONSTRUCTION OF CLASSROOM WING
 CONSTRUCTION OF TRACK & FIELD

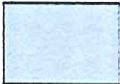

LEAMY AVENUE SITE
PHASE 3
COMPLETE DEMO OF OLDER SCHOOL

-  COMPLETED HIGH SCHOOL
-  AREA TO BE REMOVED
-  CONSTRUCTION ZONE
-  TEMPORARY FIELD

NOTES:

REMOVE REMAINING PORTION OF EXISTING SCHOOL

CONSTRUCTION OF NEW PLAYING FIELDS

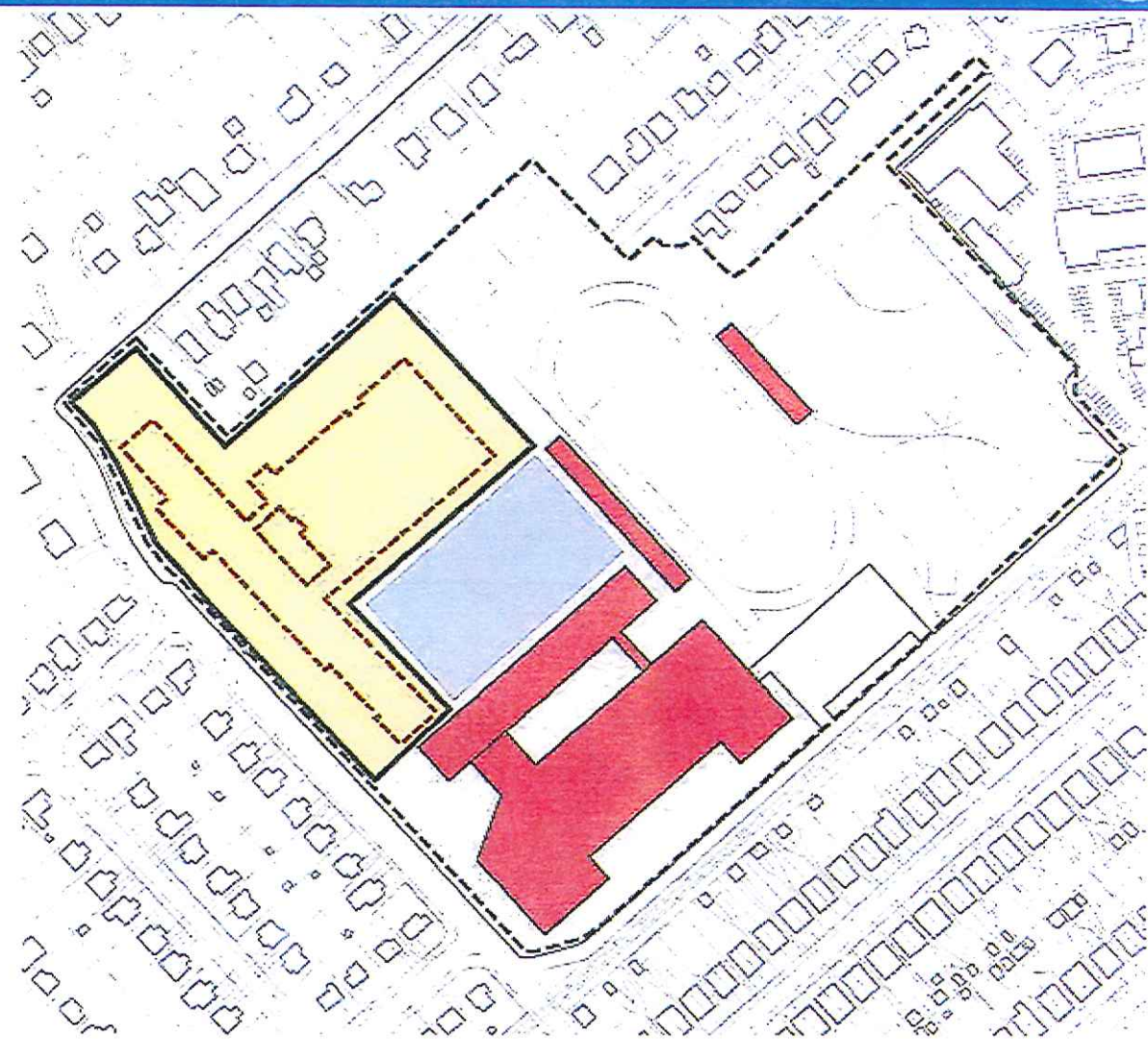

LEAMY AVENUE SITE

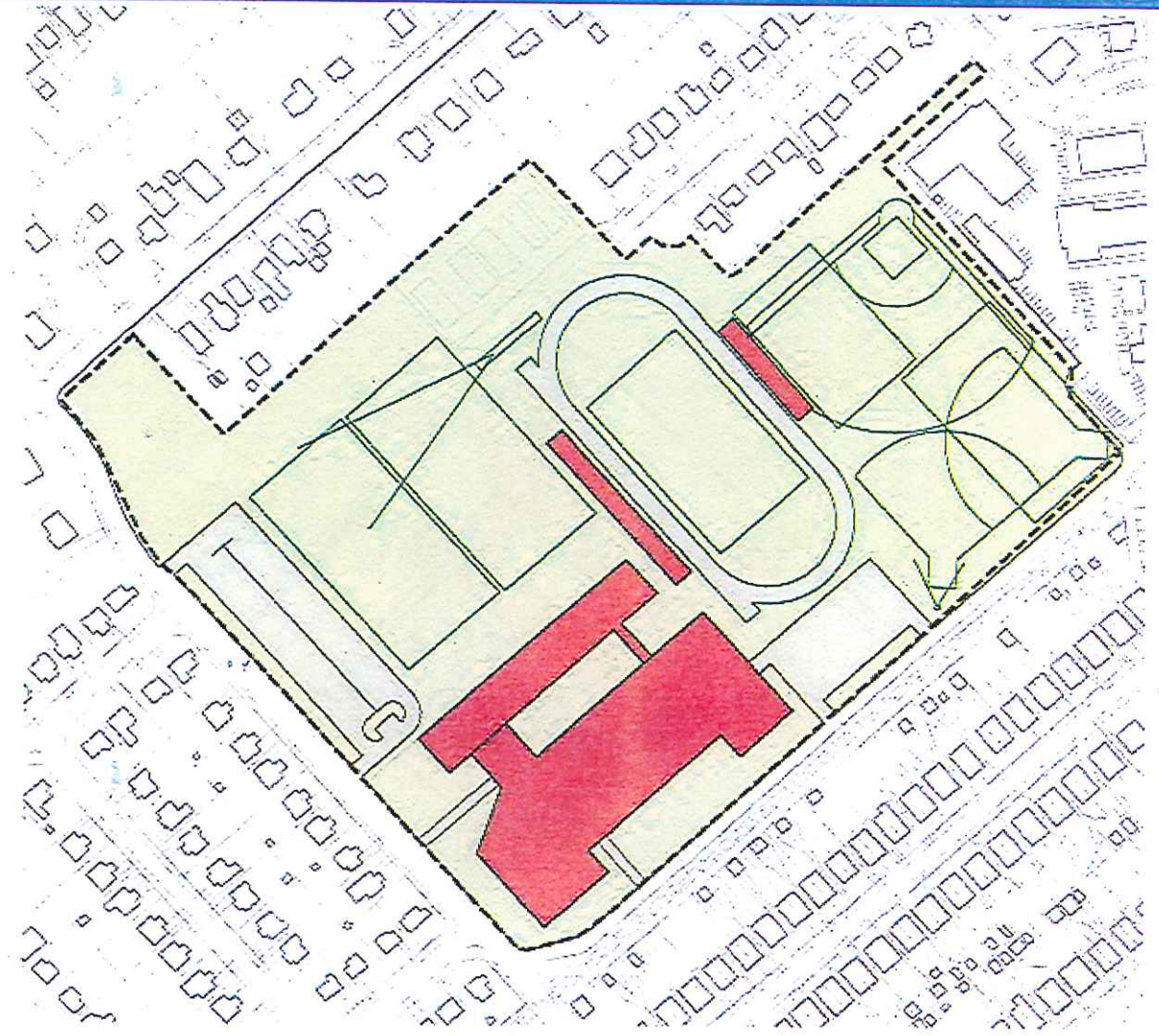

SAXER AVENUE SITE

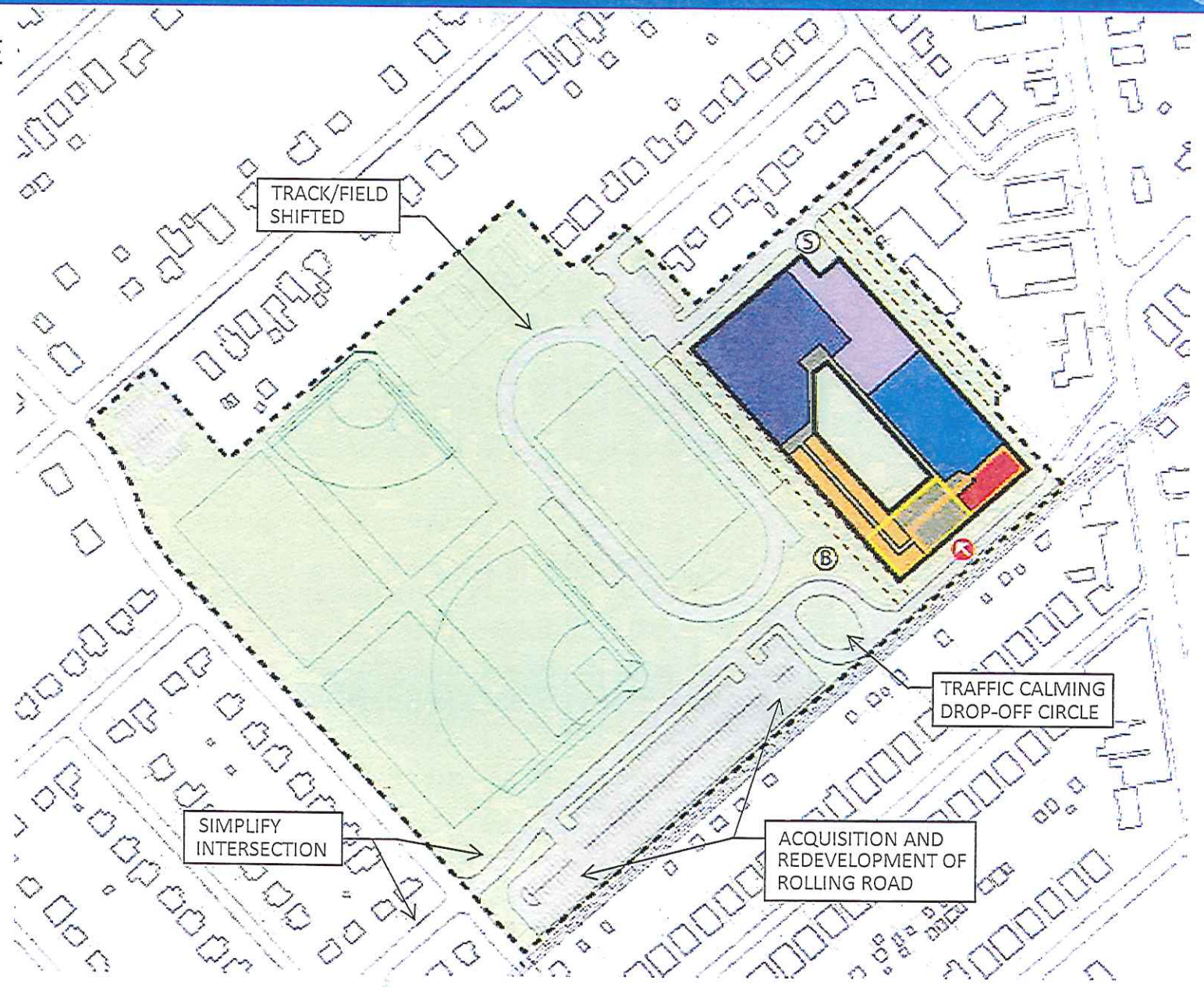

SAXER AVENUE SITE

Phasing Notes

- New School can be developed while Existing School remains fully operational
- Track and Field can be relocated prior to any other work; only rear parking would be displaced
- Geothermal Wellfield : under track or parking

